



**DAUTEL**  
*COMPETENCE 4 LIFTS*

## Contents

This manual is intended to supply you with valuable information for choosing the right variant, demonstrate how to use it properly, and illustrate the advantages of the product.

The product characteristics may differ according to the model. The values stated for deadweight are only intended to serve as a guide and may deviate according to the mounting situation, as we supply tailor-made lifts for specific mounting cases with different lifting arms and mounting plates.

**DAUTEL** offers you many sector-specific solutions: from models for transporters with a rated load of 500 kg up to heavy loads of 3000 kg at a load centre of 1000 mm. Special solutions

for trailers, semi-trailers, and trucks with low and normal trailer hitches and the **DAUTEL SLIDER DS VANB** retractable models.

Thanks to their modular design, the proven technology of the **DAUTEL LIFTER** has also found its way into the **DAUTEL FOLDER** and the retractable **DAUTEL SLIDER**.

<b>DAUTEL</b> , experience, modern production, distribution	4 – 7	<b>DAUTEL LIFTER</b> DL 1000 – 3000S	42 – 55	<b>DAUTEL</b> Customer Service	83
<b>DAUTEL LIFTER</b> , Lift quality attributes	8 – 16	<b>DAUTEL LIFTER</b> for trucks with low couplings	56 – 57	<b>DAUTEL EXPORTLIFTER</b>	84 – 85
<b>DAUTEL LIFTER</b> for trailers	17	<b>DAUTEL FOLDER</b>	58 – 59		
<b>DAUTEL</b> platform systems/ roll stops	18 – 23	<b>DAUTEL SLIDER</b> DS 750/950VE	60 – 61		
<b>DAUTEL</b> load securing	24	<b>DAUTEL LIFTERFLEX/SLIDERFLEX</b>	62 – 63		
Electronic charging cable with charge monitor	25	<b>DAUTEL SLIDER</b> for trucks/BDF swap bodies	64 – 65		
Product range	26	<b>DAUTEL SLIDER</b> for trucks	66 – 69		
How to determine the correct rated load	27	<b>DAUTEL SLIDER</b> 1500/2000VT			
<b>DAUTEL LIFTER</b> for vans	28 – 29	for BDF C782 volume transports	70 – 71		
<b>DAUTEL FLEETLIFTER</b> DFL 500/750	30 – 31	<b>DAUTEL SLIDER</b> for semi-trailers	72 – 73		
<b>DAUTEL LIFTER</b> DL 500 – 950B	32 – 37	Additional equipment	74 – 75		
<b>DAUTEL FLEETLIFTER</b> DFL 1000 – 1500	38 – 41	For every application in every industry	76		
		Recommended truck equipment	77		
		How to request a quotation	78		
		Technical data	79 – 82		

Typically **DAUTEL**

## competence 4 lifts

- Tradition and progress
- Modern production facilities
- Design and development work performed in house
- Worldwide distribution
- **Four**-cylinder technology used throughout (compact, high-performance lift)
- Personalised attachment analysis – fast and dependable
- Intelligent, market-driven solutions, ideal for all transport and logistics uses
- Easy and user-friendly operation



**Professionals with over 80 years of experience**

## tradition 4 lifts

Numerous intelligent solutions combined with high-quality materials set new standards, e.g.:

- Retractable tail-gate lifts
- Watertight plastic box for outdoor operation
- Easy and logical operation
- Two-point foot control which can be driven over under load
- **DAUTEL** Check control
- Low-maintenance compound bearing bushes
- Separate control circuits for outdoor-operation foot control



## Tradition paired with progress

- Continuously developed product components
- The youngest and most up-to-date product range on the market
- Modern production facilities using the latest manufacturing processes
- Durable, long-lasting products



## DAUTEL worldwide

**Italy** • DAUTEL s.r.l. • Via Torino 3/5 • 10814 Varedo (MB)

Tel. +39 029 9042343 • Fax +39 029 1088741 • info@dautel.it

**Austria** • Gerald Sallaberger • Tel. +43 664 2438078

gerald.sallaberger@dautel.de

**Switzerland** • DAUTEL AG • Transportrationalisierung • Mülibach 203 • 8217 Wilchingen

Tel. +41 5268 70838 • Fax +41 5268 70820 • info@dautel-cargotech.ch

In other countries, we work hand-in-hand with general representatives, for example in Bulgaria, Chile, Israel, Malaysia, The Netherlands, Poland, Russia, Saudi Arabia, Spain, and Turkey among others.



Low deadweight

## Compact, high-performance lift

- Double the power and twice the safety thanks to **four**-cylinder technology
- Round supporting tube construction is highly warp-resistant
- High ground clearance
- Hydraulic ground adaptation
- Three-section under-run guard, gaiters and guard tubes come as standard



Work all 4 seasons

## Optimal corrosion protection

- All steel components are pretreated and thick-layer CDP-coated
- They achieve 700 hours of resistance in a salt spray test
- Lift (supporting tube, lifting arm, under-run guard, and suspension plates) is optionally available in a hot-dip galvanised variant
- Platform can either be painted or anodised (10µ EV1) upon request

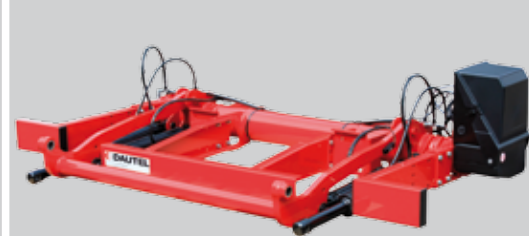
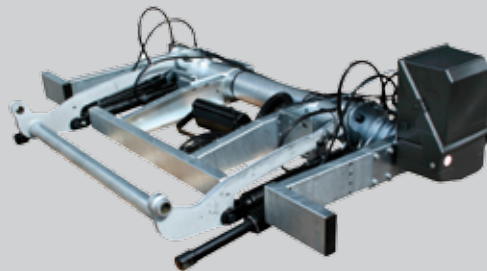

## Hydraulic cylinders

### Powerful and durable

- Dautel's own design
- Double hard-chrome-plated piston rods
- Optimal guidance thanks to use of multiple support rings
- Double seal system
- Gaiters and guard tubes come as standard
- Best possible protection from dirt and stones



Service-friendly drive

## Guaranteed all-round safety

- 2 kW motor with thermal protection switch (from model DL 1000)
- Offers weight-optimised moisture and stone protection for the unit housing
- Redundancy provided by separate circuits for foot control and operating unit
- Thermoplast hydraulic hoses with zinc nickel fitting
- Robust central electronics with easily replaceable switch and indicator logic unit
- Emergency manual operation also possible with a cable jumper



Powerful and reliable

## Hydraulic tilting

- Hydraulic pressure booster in the supporting tube
- Twice the safety thanks to position-dependent activation of the pressure transducer
- Horizontal retraction without expensive sensor systems

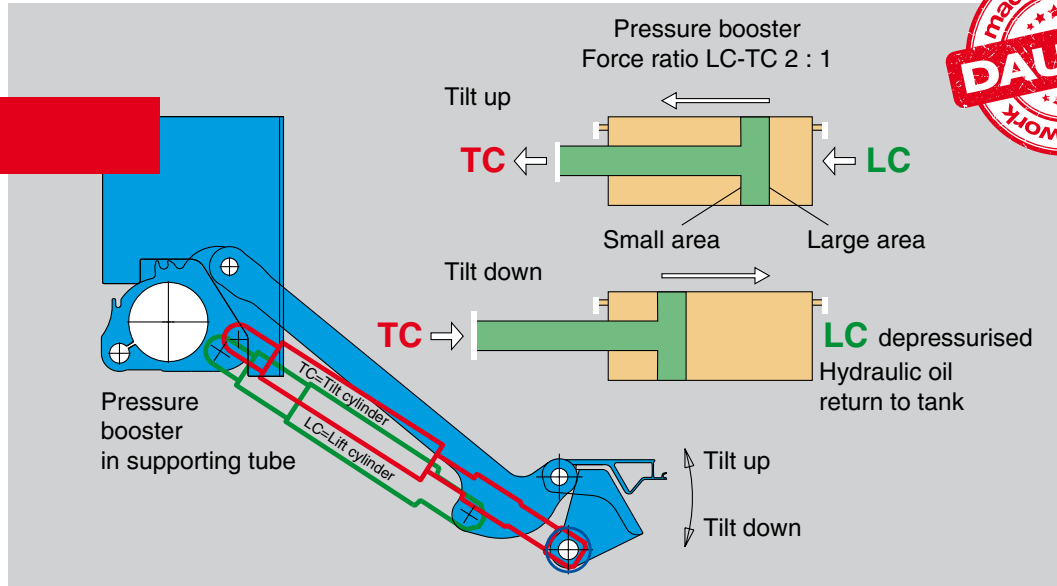

Simply quality

## User-friendly operation

- Ergonomically positioned controls
- Dirt protection provided by self-closing lid
- Components can be replaced individually
- Visual voltage monitoring via flashing lights on the platform and electrically by deactivation of the foot and spiral cable remote control



Always resilient

## Two-point foot control

- Load-independent proximity switch
- No rollover resistance, as it is integrated into the platform
- Logical operating sequence

### Optional:

Spiral cable remote control or wireless remote control with safety point

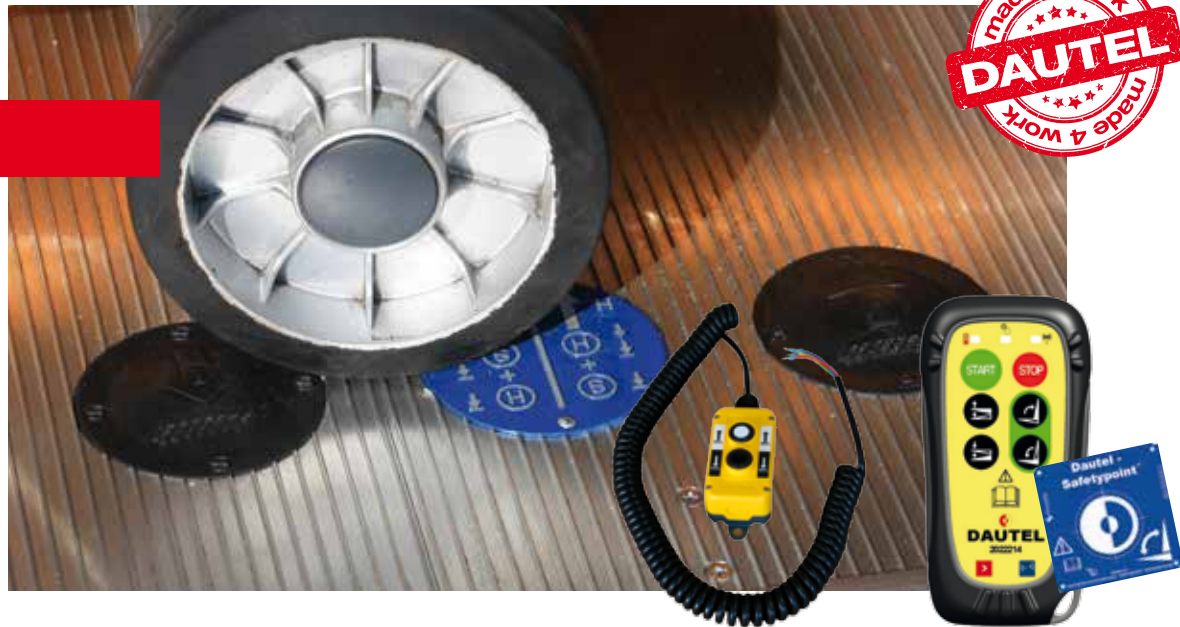

For the most demanding situations

## Long-lasting and low-maintenance

- Increased stability thanks to the large bearing surfaces
- Equipped with Duo-Longlife bearings made from a filament-wound, glass-fibre-reinforced compound
- Highly corrosion-resistant zinc nickel-coated pins with lubricant holes
- Thermoplast hydraulic hoses with zinc nickel fitting
- Conventional add-on lubrication system also possible upon request

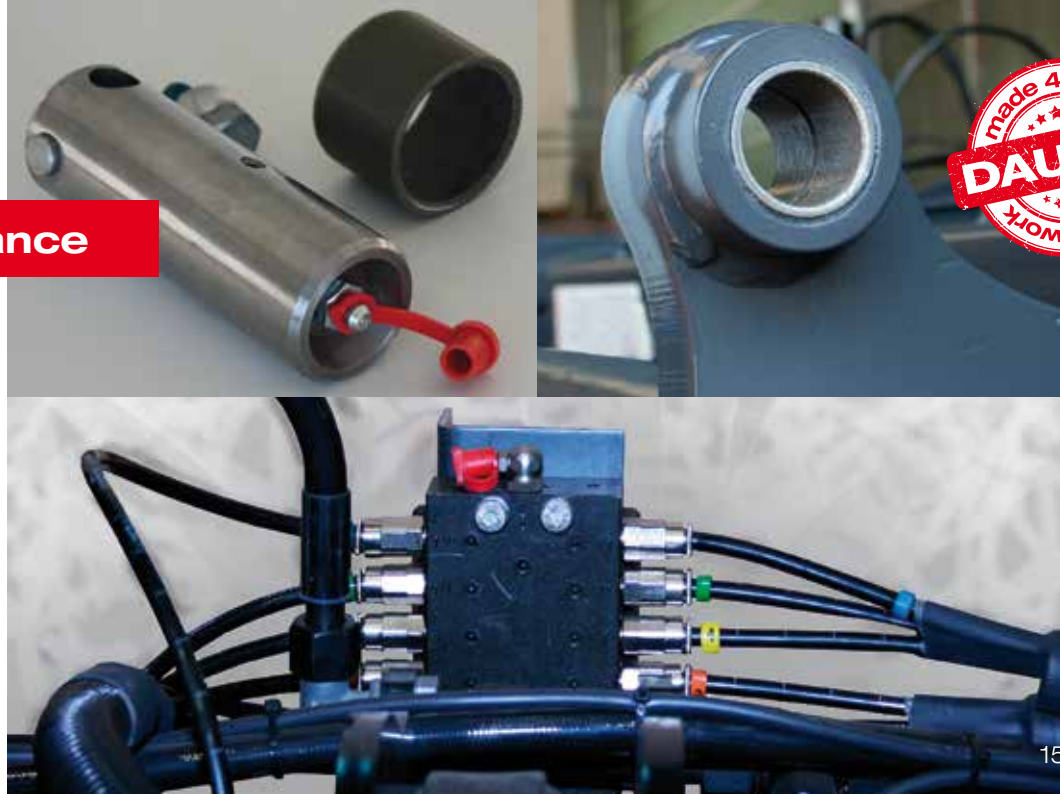

## Piek certified

### Very quiet in operation

- The Piek Certificaat confirms that Dautel achieves average operating noise of 59 db(A) with its products
- Sound-absorbing platform covering – especially for nighttime deliveries
- Noise-reduced closing is available with seal system variant 1
- Roll stop V1, noise-optimised
- 3 kW motor, noise-optimised



Well attached

## For trailers / semi-trailers

- Coding switch on the control with a magnetic cap locks the lift
- Mounting adapter designed for semi-trailers, turntable trailers, and centre-axle trailers
- Can be bolted using brackets for track widths of 980mm or 1300mm

In order to supply the **DAUTEL** *LIFTER / SLIDER* with a reliable source of power, we recommend using an auxiliary battery system

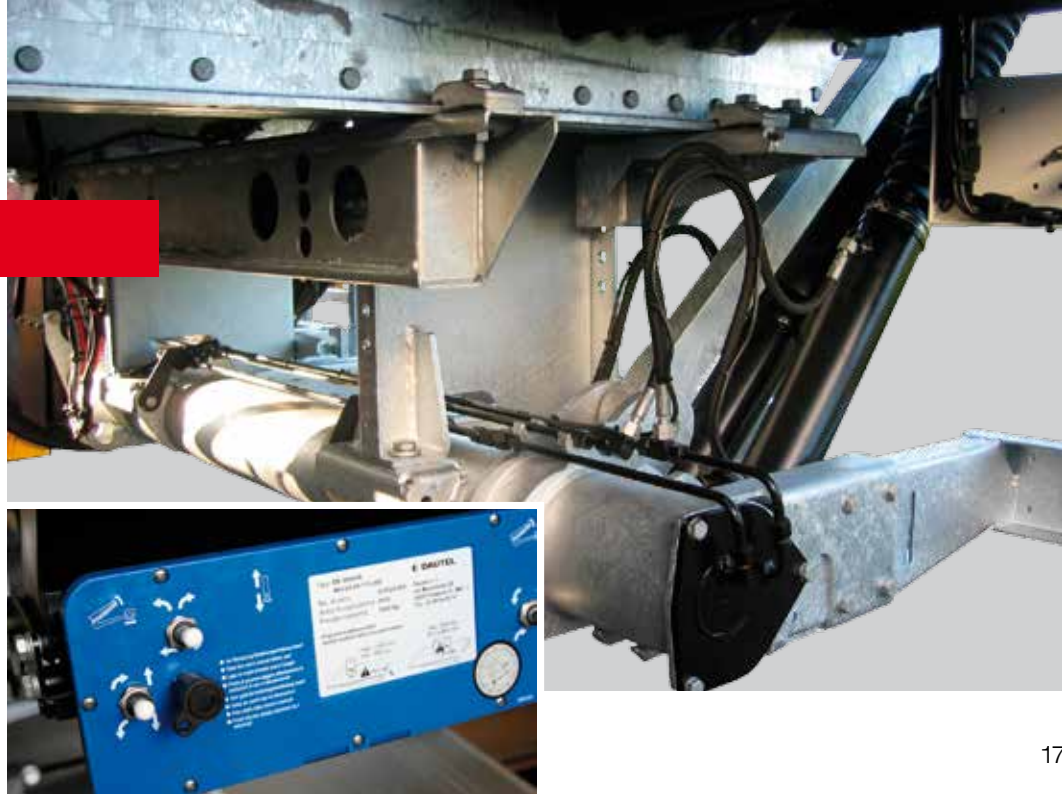

The operator's second workplace:

## Aluminium platform, type N

### Robust and economical

- Flat design with 40-mm profiles transverse to the driving direction connected by a cold jointing process and 2 welded aluminium substructures that are warp-resistant and rollover resistant. CDP-painted steel connecting heads.
- Anti-slip surface, classification of the anti-slip property as per DIN 51130 R11 in downwardly inclined direction. New longitudinal and lateral optional "ANTI-SLIP" surface, R13.
- Optional Fixorand profile for mounting side bridging plates
- For **DAUTEL LIFTER** DL 1000 – 2500L with a load centre of 1000 mm
- Roll stop type A1, A2, F1 and V1 available



The operator's second workplace:

## Aluminium platform, type K

Ideal for your advertising message

- Robust design with 40 mm profiles oriented lengthways in the direction of travel, CPD-painted steel connecting heads
- Optional Fixorand profile
- For **DAUTEL LIFTER** DL 1000 – 2000S
- Roll stop type A1, F1 and V1 available



For heavy-duty use:

## Aluminium platform, type P

- Flat design with 40-mm profiles transverse to the driving direction, welded on both sides, and 2 welded aluminium substructures
- Thanks to the short box sections and extremely strong top fascia profile on the DL 2500L/S and 3000S, their warp-resistance and over-roll strength are exemplary
- Classification of the slip-resistant properties acc. to DIN 51130, R11 in the tilting direction. New longitudinal and lateral optional additional longitudinal milling or "ANTI-SLIP" surface, R13.
- Aluminium edging profiles with low-wear V2A tips
- Optional Fixorand profile and anodised silver colour
- For **DAUTEL LIFTER** from DL 1500S
- Roll stop type A1, F1 and V1 available



For extreme applications:

## Hot-dip galvanised steel platform

- The steel platform is hot-dip galvanised inside and out and therefore offers the highest corrosion protection.
- Available on **DAUTEL LIFTER** from DL 1500S, platform height 1800 mm, 2100 mm, 2200 mm, 2300 and 2400 mm. With optional roll stop type F1, 1000 mm wide for 2 roller containers with wheels with  $\varnothing$  max. 120 mm, position approx. 470 mm before the tip, optionally available with Fixorand profile.
- Classification of the permanently slip-resistant properties acc. to DIN 51130, R11 in all directions.
- Basic steel platform: primed on the outside with substructures and lateral profiles. Optional with casing panel between the substructures or also on the right and left of the substructures.



## Aluminium platform

# Secure retention of your rolling containers

The reliable roll stop is a key mark of quality in your logistics supply chain.

**DAUTEL** provides roll stops for roller containers with a max. wheel diameter of 120 mm or 200 mm. They can be operated by foot individually or open up to three at the same time, are separately lockable and can be driven over when the platform tip is in use.

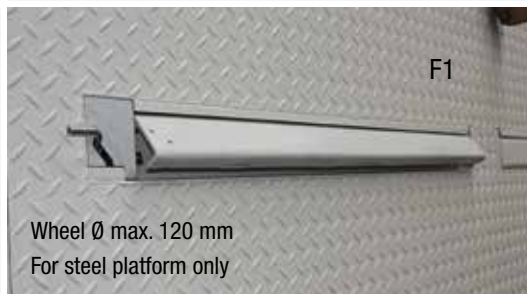
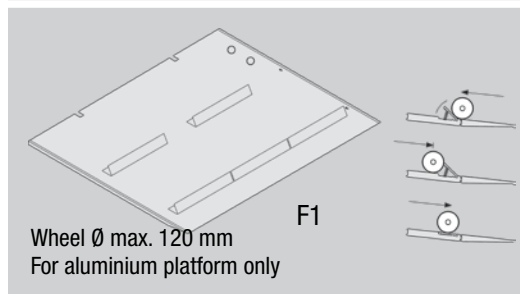
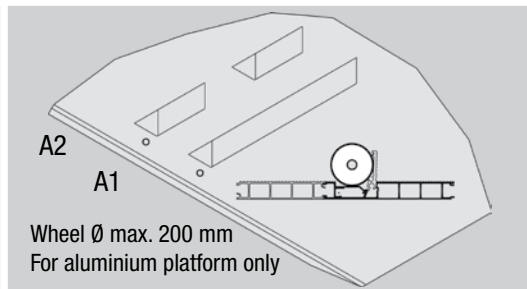
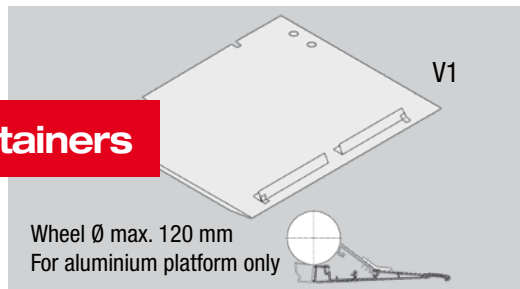

## Rugged flashing light

### Modern LED technology

The flashing lights on the platform shine using the latest LED technology. They are rugged and have exceptionally long life.

- Rollover resistant housing with cage construction made from diecast zinc
- External chamfered edges with repellent effect on rear
- Increased safety thanks to the lateral illumination provided by the LEDs
- Plug connections on cable
- Watertight LED technology compliant with IP69
- Optional protection angle piece for indicator lights available



## Load securing

- **DAUTEL RAIN Lock:** DEKRA-certified according to EN 12642, EN 12195 and VDI 2700 for a payload up to 18 t.
- The self-closing system locks the platform to the reinforced rain strip on the body. The platform engages and disengages from the RAIN Lock during the closing process with the optional automatic sequence control system.
- **DAUTEL LIFT Lock:** DEKRA-certified up to a payload of 27 t. The locking bolt mechanism integrated into the platform on both sides, controlled via a movement sequence, as a form-locking, self-closing platform locking device with the body gantry. **DAUTEL LIFTER** DL 1000 – 3000S up to 2400 mm platform height achieve build stability in accordance with DIN EN 12642 Code XL Annex A without additional fasteners, and a payload of up to 20.1 t depending on installation situation.



## Electronic charging cable with charge monitor

### SmartCharge SC

- Same technology as used in ABS plug connection
- Standardised PIN assignment, truck manufacturer / tail-gate lift manufacturer
- Malfunction is indicated by a flashing signal in the driver's cab/on the electronics control module
- Properly charged batteries increase operational reliability
- Less wear on the drive motor
- Simple, quick installation
- Parts kits for trucks, trailers, and semi-trailers
- PLUG&CHARGE connection on the drive unit

**DAUTEL LIFTER** – it doesn't get any easier than this!

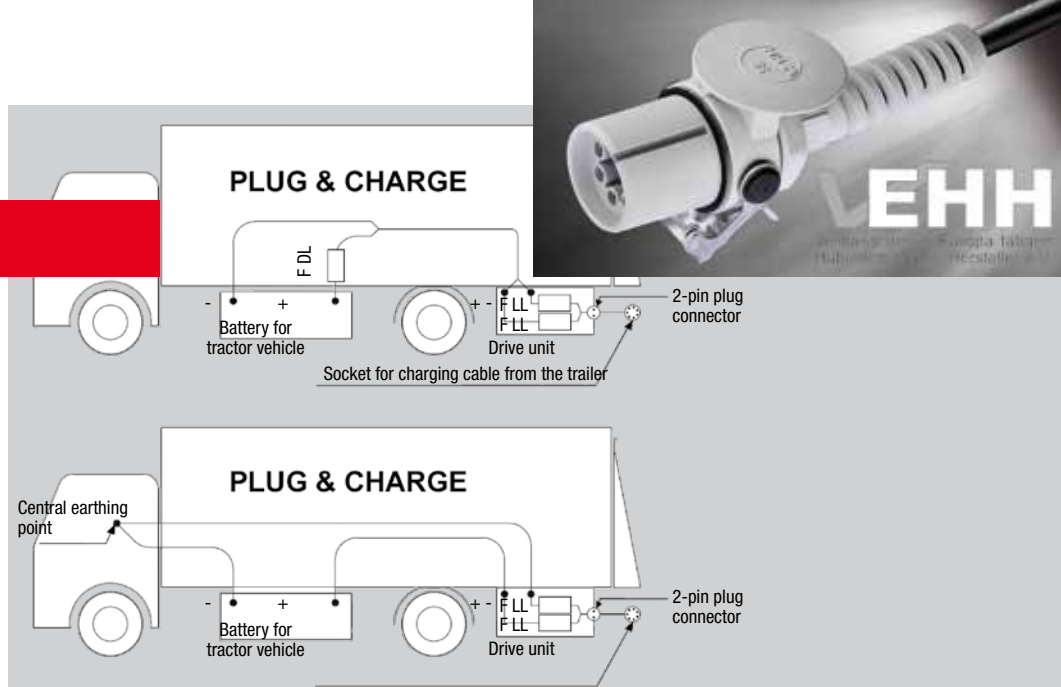

## Product range

Standard	Rated load	LC*
<b>DAUTEL FLEETLIFTER</b> DFL 750	750 kg	600 mm
<b>DAUTEL FLEETLIFTER</b> DFL 1000	1000 kg	600 mm
<b>DAUTEL FLEETLIFTER</b> DFL 1500	1500 kg	600 mm
<b>DAUTEL LIFTER</b> DL 750	750 kg	600 mm
<b>DAUTEL LIFTER</b> DL 950VB	1000 kg	500 mm
<b>DAUTEL LIFTER</b> DL 1000	1000 kg	700 mm
<b>DAUTEL LIFTER</b> DL 1500L	1500 kg	600 mm
<b>DAUTEL LIFTER</b> DL 1500S	1500 kg	1000 mm
<b>DAUTEL LIFTER</b> DL 2000L	2000 kg	750 mm
<b>DAUTEL LIFTER</b> DL 2000S	2000 kg	1000 mm
<b>DAUTEL LIFTER</b> DL 2500L	2500 kg	1000 mm
<b>DAUTEL LIFTER</b> DL 2500S	2500 kg	1200 mm
<b>DAUTEL LIFTER</b> DL 3000S	3000 kg	1000 mm

Standard for low coupling	Rated load	LC*
<b>DAUTEL LIFTER</b> DL 2000T	2000 kg	1000 mm
<b>DAUTEL LIFTER</b> DL 2500T	2500 kg	800 mm
Folding	Rated load	LC*
<b>DAUTEL FOLDER</b> DF 1000	1000 kg	700 mm
<b>DAUTEL FOLDER</b> DF 1500L	1500 kg	600 mm
Retractable, double-fold	Rated load	LC*
<b>DAUTEL SLIDER</b> DS 750VE	750 kg	600 mm
<b>DAUTEL SLIDER</b> DS 950VE	1000 kg	500 mm
<b>DAUTEL SLIDER</b> DS 1500VAL	1500 kg	600 mm
<b>DAUTEL SLIDER</b> DS 2000VAL	2000 kg	750 mm
<b>DAUTEL SLIDER</b> DS 1500VA	1500 kg	1000 mm
<b>DAUTEL SLIDER</b> DS 2000VA	2000 kg	1000 mm

Retractable, single-fold	Rated load	LC*
<b>DAUTEL SLIDER</b> DS 750VE	750 kg	600 mm
<b>DAUTEL SLIDER</b> DS 950VE	1000 kg	500 mm
<b>DAUTEL SLIDER</b> DS 1500VAL	1500 kg	600 mm
<b>DAUTEL SLIDER</b> DS 2000VAL	2000 kg	750 mm
<b>DAUTEL SLIDER</b> DS 1500VA	1500 kg	1000 mm
<b>DAUTEL SLIDER</b> DS 2000VA	2000 kg	1000 mm
<b>DAUTEL SLIDER</b> DS 2500VA	2500 kg	960 mm
<b>DAUTEL SLIDER</b> DS 3000VA	3000 kg	800 mm
<b>DAUTEL SLIDER</b> DS 1500VT	1500 kg	800 mm
<b>DAUTEL SLIDER</b> DS 2000VT	2000 kg	600 mm
<b>DAUTEL SLIDER</b> DS 1500VT	1500 kg	800 mm
<b>DAUTEL SLIDER</b> DS 2000VT	2000 kg	600 mm
Retractable, single-fold semi-trailer / centre-axle trailer	Rated load	LC*
<b>DAUTEL SLIDER</b> DS 1500VBL	1500 kg	600 mm
<b>DAUTEL SLIDER</b> DS 2000VBL	2000 kg	750 mm
<b>DAUTEL SLIDER</b> DS 2000VB	2000 kg	1000 mm
<b>DAUTEL SLIDER</b> DS 3000VB	3000 kg	800 mm

\* The load centre is understood as being measured from the start of the platform and in the centre of the platform.

How to determine:

## The correct rated load + load centre

When purchasing a tail-gate lift, the objective application conditions are frequently not taken into consideration. The required rated load is determined, for example, according to customer specifications or the vehicle payload.

The rated load of a tail-gate lift refers to a load centre in relation to the beginning and in the middle of the platform.

The further the load is moved towards the tip of the platform, the greater the leverage effect and the lower the rated load.

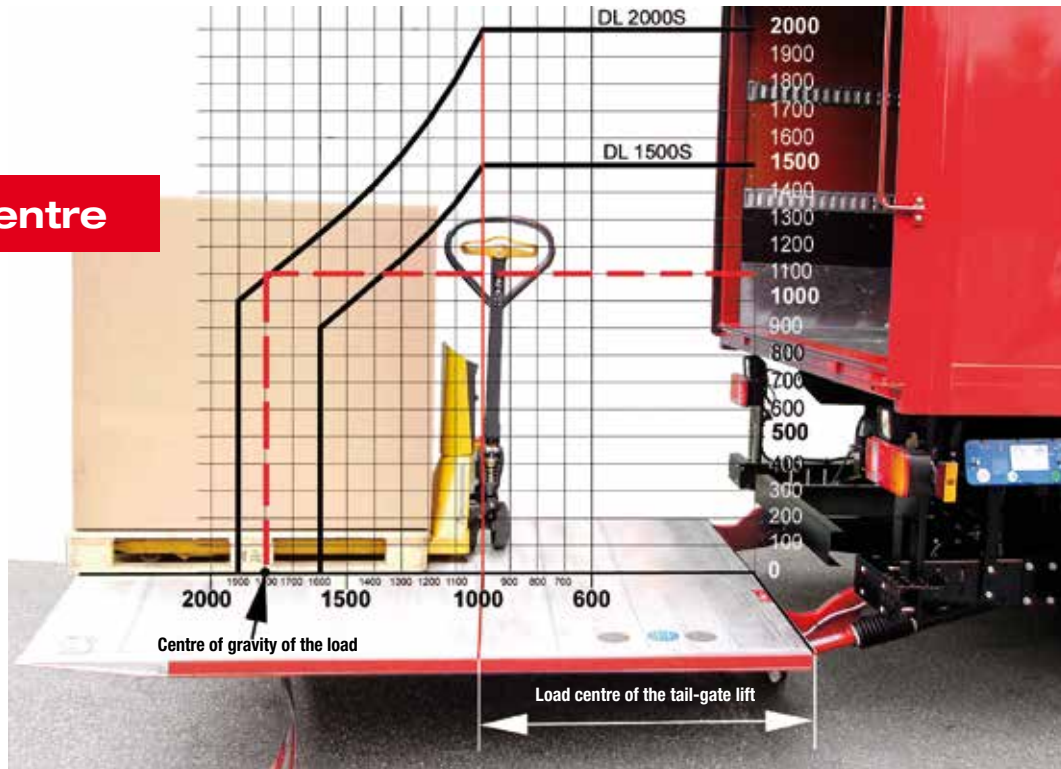

## DAUTEL *LIFTER* DL 500K

With the **DAUTEL** *LIFTER* DL 500K on your van, with the large platform you can load and unload roller containers, pallets, or heavy goods with a deadweight up to 500/750 kg unaided, depending on the type of van . The Lifter's low deadweight from approx. 185 kg, its ease of operation via wireless remote with safety point, the hot-dip galvanised four-cylinder lift and its high ground clearance are further benefits. Installation is quick and easy using vehicle-specific mounting brackets.



### Technical data

**Rated load:** 500/750 kg · **Deadweight:** from approx. 185 kg

## The ideal logistics solution

**LC\* in longitudinal direction:** 600 mm

**LC\* in transverse direction:** middle, 50% of the nominal load on one side

**Construction:** Four-cylinder lift, double-acting tilt cylinder, the platform is hydraulically opened

**Platform:** Aluminium, flat model, height 1450/1600 mm

**Tilt angle of the platform:** + 90° to - 10°

**For van models:** Iveco Daily, Mercedes-Benz Sprinter/Volkswagen Crafter 3.5 t, wheelbase 3625 and 4325 mm, 5 t wheelbase 4325 mm, Mercedes-Benz Vario

**Optional:** With towing bracket and removable ball coupling

Arm length (in mm)	570	670
F max. = loading height	1016	1161
D max. = distance from mounting on supporting tube to top edge of loading platform	567	653
D min. = distance from mounting on supporting tube to top edge of loading platform	358	408
G max. = distance from mounting of supporting tube to roadway	449	508
E max. = installation space	654	741
E min. = installation space	446	496
C min. = final height	80	85
C max. = final height	138	138

\*Load centre

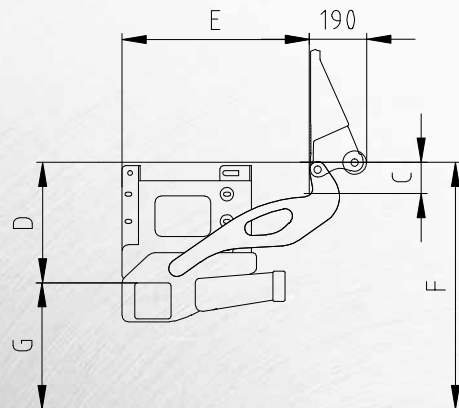

## DAUTEL *FLEETLIFTER* DFL 500/750

The **DAUTEL *FLEETLIFTER*** DFL 500/750 is the optimum solution for the needs of the market for high payloads on a transporter chassis. The robust four-cylinder design with 2 attachable signs and fold-down under-run guard results in a deadweight of only approx. 180 kg (for a 1455 mm platform).



### DL 500 load diagram

Load centre	Rated load
600 mm	500 kg
700 mm	430 kg
800 mm	375 kg

### DL 750 load diagram

Load centre	Rated load
600 mm	750 kg
700 mm	640 kg
800 mm	560 kg

### High performance

**Rated load:** 500/750 · **Deadweight:** from approx. 180 kg

## Four-cylinder lightweight design

**LC\* in longitudinal direction:** 600 mm

**LC\* in transverse direction:** middle, 50% of the nominal load on one side

**Construction:** Four-cylinder lift, the platform is hydraulically opened

**Lifting arm length:** 600 mm, 670 mm

**Platform:** Aluminium, flat model, crossways-ribbed surface, height 1455, 1605 mm

**For transporter chassis:** up to 5.5 t, for Iveco Daily, Mercedes-Benz Sprinter, Volkswagen Crafter, Opel Movano, Ford Transit and Renault Master

	DFL 500/750	
Arm length (in mm)	600	670
F max. = loading height	941	1025
D max. = distance from supporting tube to top edge of loading platform	496	545
D min. = distance from supporting tube to top edge of loading platform	350	382
G max. = supporting tube to roadway	445	480
E max. = installation space	691	751
E min. = installation space	572	619
C min. = final height	97	115
C max. = final height	119	132

Platform height minus 48 mm = OK loading area to platform tip

\*Load centre

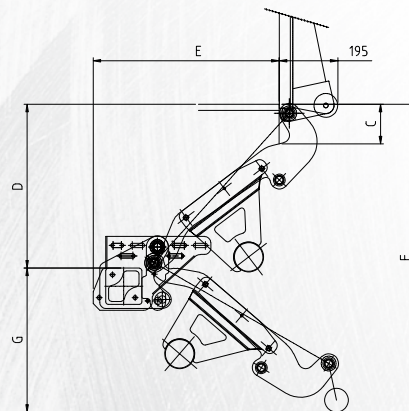

## DAUTEL LIFTER DL 500/750

The **DAUTEL LIFTER** DL 500/750 offer the same design features as the large **DAUTEL LIFTER**.

Dependable, functionally reliable, long-lasting, and service-friendly, built for continuous use by professional operators. The wide, warp-resistant lift is designed for installation conditions on transporter chassis and offers a large slope angle and high ground clearance.



### DL 500 load diagram

Load centre	Rated load
600 mm	500 kg
700 mm	430 kg
800 mm	375 kg

### DL 750 load diagram

Load centre	Rated load
600 mm	750 kg
700 mm	640 kg
800 mm	560 kg

## High performance

**Rated load:** 500/750 · **Deadweight:** from approx. 200 kg

## Light and robust

Wide, warp-resistant lift for max. platform width 2520 mm.

**LC\* in longitudinal direction:** 600 mm

**LC\* in transverse direction:** middle, 50% of the nominal load on one side

**Construction:** Two lift & two tilt cylinders, the platform is hydraulically opened

**Lifting arm length:** 600 mm, 670 mm

**Platform:** Aluminium, flat model, crossways-ribbed surface, height

1605 mm, 1805 mm

**For transporter chassis up to 6.5 t**

	DL 500/750	
Arm length (in mm)	600	670
F max. = loading height	1069	1171
D max. = distance from supporting tube to top edge of loading platform	569	626
D min. = distance from supporting tube to top edge of loading platform	378	440
G max. = supporting tube to roadway	500	545
E max. = installation space	647	692
E min. = installation space	472	512
C min. = final height	105	115
C max. = final height	132	132

Platform height minus 48 mm = OK loading area to platform tip

\*Load centre

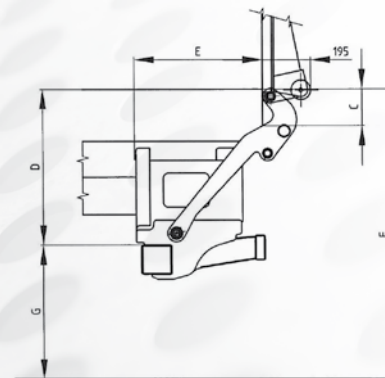

## DAUTEL *LIFTER* DL 950A

The **DAUTEL** *LIFTER* DL 950A offer the same design features as the large **DAUTEL** *LIFTER*. Dependable, functionally reliable, long-lasting, and service-friendly, built for continuous use by professional operators. The lift is designed for installation conditions on transporter chassis and offers a large slope angle and high ground clearance.



DL 950 load diagram

Load centre	Rated load
500 mm	1000 kg
600 mm	830 kg
700 mm	710 kg

## High performance

**Rated load:** 1000 kg · **Deadweight:** from approx. 245 kg

**1000 kg for transporter**

**Variant A:** Narrow, hot-dip galvanised lift for max. platform width 2200 mm, for installation between the chassis frame, generous clearance for tail lights

**LC\* in longitudinal direction:** 500 mm with load of 1000 kg

**LC\* in transverse direction:** middle, 50% of the nominal load on one side

**Construction:** Four-cylinder lift, the platform is hydraulically opened

**Lifting arm length:** 570 mm, 670 mm

**Platform:** Aluminium, flat model, crossways-ribbed surface, height 1605 mm

**For transporter chassis:** up to 5 t, preferably for Iveco Daily, Mercedes-Benz Sprinter, Volkswagen Crafter

	DL 950A	
Arm length (in mm)	570	670
F max. = loading height	925	1055
D max. = distance from supporting tube to top edge of loading platform	476	547
D min. = distance from supporting tube to top edge of loading platform	358	408
G max. = supporting tube to roadway	449	508
E max. = installation space	654	741
E min. = installation space	564	634
C min. = final height	80	85
C max. = final height	120	120

Platform height minus 48 mm = OK loading area to platform tip

\*Load centre

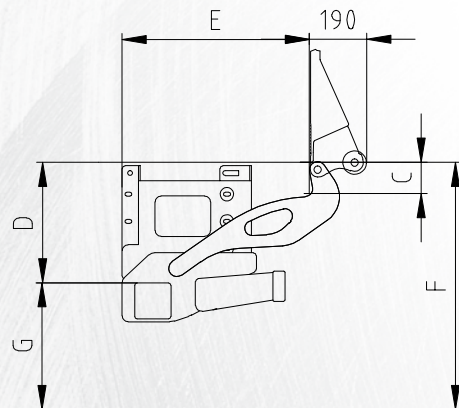

## DAUTEL *LIFTER* DL 950B

The **DAUTEL** *LIFTER* DL 950B offer the same design features as the large **DAUTEL** *LIFTER*.

Dependable, functionally reliable, long-lasting, and service-friendly, built for continuous use by professional operators. The wide, warp-resistant lift is designed for installation conditions on transporter chassis and offers a large slope angle and high ground clearance.

**DAUTEL** offers tail-gate lifts for installation on the left or right on the vehicle rear in the driving direction.



DL 950 load diagram

Load centre	Rated load
500 mm	1000 kg
600 mm	830 kg
700 mm	710 kg

### High performance

**Rated load:** 1000 kg · **Deadweight:** from approx. 255 kg

**1000 kg for transporter**

**Variant B:** Wide, warp-resistant lift for max. platform width 2520 mm, for installation on outside of chassis frame

**LC\* in longitudinal direction:** 500 mm with load of 1000 kg

**LC\* in transverse direction:** middle, 50% of the nominal load on one side

**Construction:** Two lift & two tilt cylinders, the platform is hydraulically opened

**Lifting arm length:** 570 mm, 670 mm

**Platform:** Aluminium, flat model, crossways-ribbed surface, height 1605 mm, 1805 mm

**For transporter chassis:** preferably for Iveco Daily up to 6.5 t, Mercedes-Benz Sprinter, Volkswagen Crafter up to 5 t, and trailers up to 3.5 t

	DL 950B	
Arm length (in mm)	570	670
F max. = loading height	925	1055
D max. = distance from supporting tube to top edge of loading platform	476	547
D min. = distance from supporting tube to top edge of loading platform	358	408
G max. = supporting tube to roadway	449	508
E max. = installation space	654	741
E min. = installation space	564	634
C min. = final height	80	85
C max. = final height	120	120

Platform height minus 48 mm = OK loading area to platform tip

\*Load centre

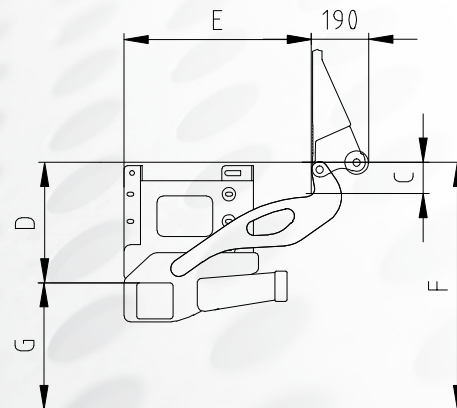

## DAUTEL *FLEETLIFTER* DFL 1000

The **DAUTEL** *FLEETLIFTER* DFL 1000 is designed for universal use in delivery traffic for all sectors, for lightweight loads up to 1000 kg at a load centre of 600 mm from the start/centre of the platform. The robust four-cylinder design with 2 attachable signs, no continuous supporting tube, with single-part, fold-down under-run guard, offers the user the maximum payload for their truck with a very low deadweight of just approx. 255 kg. The platform is hydraulically opened. As determined by the vehicle system and in order to reduce improper use, the platform height is 1800 mm. It can be installed on trucks with a permitted total weight of 7.49 t with a truck frame width of 848–864 mm.



## DAUTEL FLEETLIFTER

Rated load: 1000 kg

**For light delivery traffic**

**Deadweight:** approx. 255 kg

**Load torque:** 6 kNm

**LC\* in longitudinal direction:** 600 mm

**LC\* in transverse direction:** middle, 50% of the nominal load on one side

**Construction:** Two lift & two tilt cylinders, the platform is hydraulically opened

**Lifting arm length:** 770 mm

**Platform:** Aluminium, flat design, height 1805 mm, width 2520 mm, with 2 V1 roll stops V1 for max. wheel Ø 120 mm

**Mounting:** For trucks of frame width 848 – 864 mm and max. 7.49 t permitted total weight

**Optional:** Towing bracket for ball coupling available

Arm length (in mm)	770	820
F max. = loading height	1128	1188
D max. = distance from centre of swing bolt to top edge of loading platform	555	536
D min. = distance from centre of swing bolt to top edge of loading platform	439	475
G max. = centre of swing bolt to roadway	628	652
E max. = installation space	828	865
E min. = installation space	776	813
C min. = final height	122	122
C max. = final height	129	129
Platform height minus 57 mm = OK loading area to platform tip		

\*Load centre

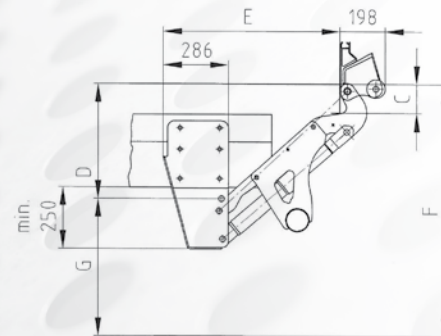

## DAUTEL *FLEETLIFTER* DFL 1500

The **DAUTEL** *FLEETLIFTER* DFL 1500 is designed for universal use in delivery traffic for all sectors, for loads up to 1500 kg at a load centre of 600 mm from the start/centre of the platform. The robust four-cylinder design with 2 attachable signs, no continuous supporting tube, with single-part, fold-down under-run guard, offers the user the maximum payload for their truck with a very low deadweight of just approx. 300 kg. The platform is hydraulically opened. As determined by the vehicle system and in order to reduce improper use, the platform height is 1800 mm. It can be installed on trucks with a permitted total weight of 16 t with a truck frame width of 848–864 mm.



## DAUTEL FLEETLIFTER

Rated load: 1500 kg

**For delivery traffic**

**Deadweight:** approx. 300 kg

**Load torque:** 6 kNm

**LC\* in longitudinal direction:** 600 mm

**LC\* in transverse direction:** middle, 50% of the nominal load on one side

**Construction:** Two lift & two tilt cylinders, the platform is hydraulically opened

**Lifting arm length:** 820, 900 mm

**Platform:** Aluminium, flat design, height 1805 mm, width 2520 mm, with 2 V1 roll stops V1 for max. wheel Ø 120 mm

**Mounting:** For trucks of frame width 848 – 864 mm and max. 16 t permitted total weight

**Optional:** Towing bracket for ball coupling available

Arm length (in mm)	820	900
F max. = loading height	1227	1328
D max. = distance from centre of swing bolt to top edge of loading platform	540	594
D min. = distance from centre of swing bolt to top edge of loading platform	394	500
G max. = centre of swing bolt to roadway	687	733
E max. = installation space	939	966
E min. = installation space	828	887
C min. = final height	115	115
C max. = final height	126	126
Platform height minus 67 mm = OK loading area to platform tip		

\*Load centre

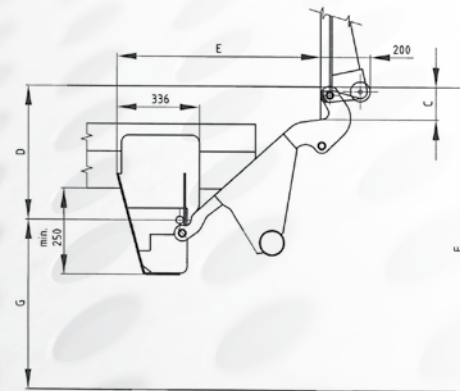

## DAUTEL *LIFTER* DL 1000

The **DAUTEL** *LIFTER* DL 1000 is designed for universal use in delivery traffic on a 7.49 t truck designed for lightweight loads up to 1000 kg, for all sectors. The robust, warp-resistant and long-lasting four-cylinder design provides the operator with the maximum payload remaining on their truck, due to the low deadweight. As determined by the vehicle system and in order to reduce improper use, the platform height is restricted to 2100 mm.

**DAUTEL** offers tail-gate lifts for installation on the left or right on the vehicle rear in the driving direction or even on the side of the vehicle.



DL 1000 load diagram

Load centre	Rated load
700 mm	1000 kg
800 mm	875 kg
900 mm	770 kg
1000 mm	600 kg

The best-selling **DAUTEL LIFTER**

Rated load: 1000 kg

**For delivery traffic**

**Deadweight, e.g.:** Aluminium platform, type N, height 1800 mm, from 350 kg

**Load torque:** 7 kNm

**LC\* in longitudinal direction:** 700 mm

**LC\* in transverse direction:** middle, 50% of the nominal load on one side

**Construction:** Two lift & two tilt cylinders, the platform is hydraulically opened

**Lifting arm length:** 800 mm, 950 mm

**Platform:** Aluminium, type K & N, height 1600/1800 mm, type N 2100 mm

**Mounting:** For trucks of frame width 750 – 800 and 848 – 864 mm and max. 16 t permitted total weight

Arm length (in mm)	800	950
F max. = loading height	1240	1434
D max. = distance from mounting on supporting tube to top edge of loading platform	715	820
D min. = distance from mounting on supporting tube to top edge of loading platform	540	623
G max. = distance from mounting of supporting tube to roadway	526	614
E max. = installation space	980	1100
E min. = installation space	845	949
C min. = final height	100	100
C max. = final height	135	135
Platform height minus 67 mm = OK loading area to platform tip		

\*Load centre

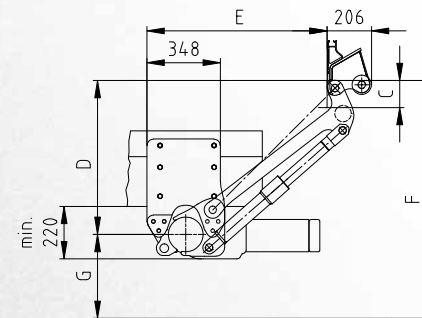

## DAUTEL *LIFTER* DL 1500L

The **DAUTEL** *LIFTER* DL 1500L is designed for universal use in delivery traffic on a 7.49 – 16 t truck designed for lightweight loads up to 1500 kg, taking account of the load diagram. The robust, warp-resistant and long-lasting four-cylinder design provides the operator with the maximum payload remaining on their truck, due to the low deadweight. As determined by the vehicle system and in order to reduce improper use, the platform height is restricted to 2100 mm.



## Powerful performance – Lightweight design

Rated load: 1500 kg

**For delivery traffic**

**Deadweight, e.g.:** Aluminium platform, type N, height 1800 mm, from approx. 370 kg

**Load torque:** 9 kNm

**LC\* in longitudinal direction:** 600 mm

**LC\* in transverse direction:** middle, 50% of the nominal load on one side

**Construction:** Two lift & two tilt cylinders, the platform is hydraulically opened

**Lifting arm length:** 800 mm, 950 mm

**Platform:** Aluminium, type K & N, height 1600/1800/2100 mm

**Mounting:** For trucks of frame width 848 – 864 mm and max. 15 t permitted total weight

Arm length (in mm)	800	950
F max. = loading height	1240	1434
D max. = distance from mounting on supporting tube to top edge of loading platform	715	820
D min. = distance from mounting on supporting tube to top edge of loading platform	540	623
G max. = distance from mounting of supporting tube to roadway	526	614
E max. = installation space	980	1100
E min. = installation space	845	949
C min. = final height	100	100
C max. = final height	135	135
Platform height minus 67 mm = OK loading area to platform tip		

\*Load centre

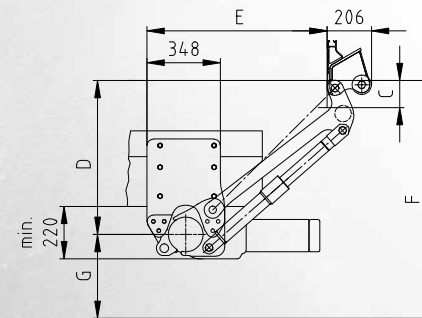

## DAUTEL *LIFTER* DL 1500S

The **DAUTEL** *LIFTER* DL 1500S is designed for universal use in the beverage trade, general cargo and delivery traffic. With its rated load of 1500 kg at a load centre of 1000 mm and the ample associated reserve capacity, it is the first choice – even for the often unknown load weights in general cargo traffic. The use of electric pallet trucks with a deadweight of approx. 500 kg and more is possible with the corresponding load weight.



DL 1500S load diagram

Load centre	Rated load
1000 mm	1500 kg
1200 mm	1250 kg
1500 mm	1000 kg
1600 mm	930 kg

**Rated load:** 1500 kg

## The powerful 1500 kg model

**Deadweight, e.g.:** Aluminium platform, type N, height 1800 mm, from approx. 455 kg

**Load torque:** 15 kNm

**LC\* in longitudinal direction:** 1000 mm

**LC\* in transverse direction:** middle, 50% of the nominal load on one side

**Construction:** Two lift & two tilt cylinders, the platform is hydraulically opened

**Lifting arm length:** 800 mm, 950 mm

**Platform:** Aluminium, type K, N & P, height 1800/2000/2100/2200/2300/2400 mm  
Steel platform primed or hot-dip galvanised on exterior

**Mounting:** For trucks, trailers, and semi-trailers

Arm length (in mm)	800	950
F max. = loading height	1354	1565
D max. = distance from mounting on supporting tube to top edge of loading platform	733	856
D min. = distance from mounting on supporting tube to top edge of loading platform	479	553
G max. = distance from mounting of supporting tube to roadway	621	709
E max. = installation space	945	1075
E min. = installation space	711	797
C min. = final height	100	100
C max. = final height	200	200
Platform height minus 67 mm = OK loading area to platform tip		

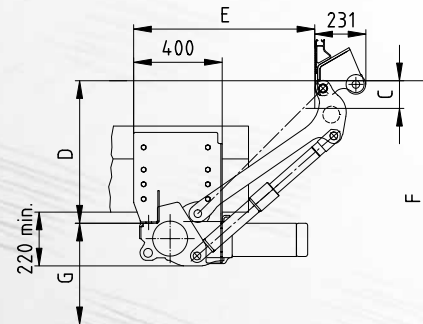

\*Load centre

## DAUTEL *LIFTER* DL 2000L

The **DAUTEL** *LIFTER* DL 2000L is designed for use in general cargo applications, delivery traffic, the beverage trade, and in food logistics. With its ample reserve capacity, it is the first choice – even for the often unknown load weights in general cargo traffic. For roller container use, up to 5 roll stops are integrated into the platforms. The use of electric pallet trucks with a deadweight of approx. 500 kg and more is possible with the corresponding load weight. The appropriate centre, if the powerful torque of the **DAUTEL** *LIFTER* DL 2000S is overdimensioned and the DL 1500S is not sufficient.



DL 2000L load diagram

Load centre	Rated load
750 mm	2000 kg
900 mm	1660 kg
1000 mm	1500 kg
1200 mm	1250 kg

**Rated load:** 2000 kg

## Powerful 2000 kg model – the alternative

**Deadweight, e.g.:** Aluminium platform, type N, height 1800 mm, from approx. 465 kg

**Load torque:** 15 kNm

**LC\* in longitudinal direction:** 750 mm

**LC\* in transverse direction:** middle, 50% of the nominal load on one side

**Construction:** Two lift & two tilt cylinders, the platform is hydraulically opened

**Lifting arm length:** 800 mm, 950 mm

**Platform:** Aluminium, type K, N & P, height 1800/2000/2100/2200/

2300/2400 mm. Steel platform primed or hot-dip galvanised on exterior

**Mounting:** For trucks, trailers, and semi-trailers

Arm length (in mm)	800	950
F max. = loading height	1354	1565
D max. = distance from mounting on supporting tube to top edge of loading platform	733	856
D min. = distance from mounting on supporting tube to top edge of loading platform	479	553
G max. = distance from mounting of supporting tube to roadway	621	709
E max. = installation space	945	1075
E min. = installation space	711	797
C min. = final height	100	100
C max. = final height	200	200
Platform height minus 67 mm = OK loading area to platform tip		

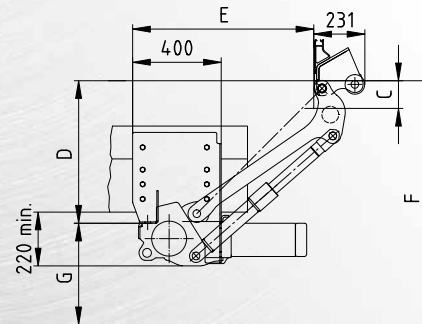

\*Load centre

## DAUTEL LIFTER DL 2000S

The **DAUTEL LIFTER DL 2000S** is designed for heavy and intensive use in the beverage industry and trade, and in food logistics. With its rated load of 2000 kg at a load centre of 1000 mm and the ample associated reserve capacity, it is the first choice. For roller container use, up to 5 roll stops are integrated into the platforms. The right choice for use with electric pallet trucks.



DL 2000S load diagram

Load centre	Rated load
1000 mm	2000 kg
1200 mm	1660 kg
1500 mm	1330 kg
1900 mm	1050 kg

**Rated load:** 2000 kg

**For professional goods distribution**

**Deadweight, e.g.:** Aluminium platform, type N, height 1800 mm, from approx. 510 kg, height 2100 mm, from approx. 520 kg

**Load torque:** 20 kNm

**LC\* in longitudinal direction:** 1000 mm

**LC\* in transverse direction:** middle, 50% of the nominal load on one side

**Construction:** Two lift & two tilt cylinders, the platform is hydraulically opened

**Lifting arm length:** 800 mm, 950 mm

**Platform:** Aluminium, type K, N & P, height 1800/2000/2100/2200/2300/2400/2505/2605/2705/2805 mm. Steel platform primed or hot-dip galvanised on exterior

**Mounting:** For trucks, trailers, and semi-trailers

Arm length (in mm)	800	950
F max. = loading height	1379	1590
D max. = distance from mounting on supporting tube to top edge of loading platform	733	856
D min. = distance from mounting on supporting tube to top edge of loading platform	479	553
G max. = distance from mounting of supporting tube to roadway	646	734
E max. = installation space	945	1075
E min. = installation space	711	797
C min. = final height	100	100
C max. = final height	200	200
Platform height minus 67 mm = OK loading area to platform tip		

\*Load centre

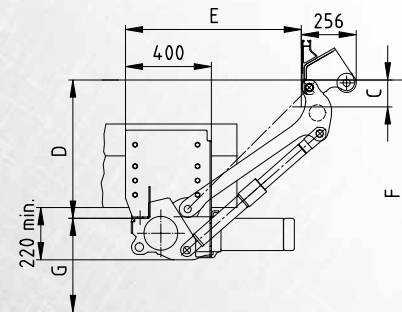

## DAUTEL *LIFTER* DL 2500L

The **DAUTEL** *LIFTER* DL 2500L is designed for heavy and intensive use in the beverage industry and trade, and in food logistics with its rated load of 2500 kg at a load centre of 1000 mm and the ample associated reserve capacity. For roller container use, up to 5 roll stops are integrated into the platforms. The right choice for use with electric pallet trucks.

The appropriate centre, if the powerful torque of the **DAUTEL** *LIFTER* DL 2500S/3000S is overdimensioned and the DL 2000S is not sufficient.



DL 2500L load diagram

Load centre	Rated load
1000 mm	2500 kg
1200 mm	2080 kg
1500 mm	1660 kg

### Professional goods classification

Rated load: 2500 kg

## For particular applications

**Deadweight, e.g.:** Aluminium platform, type P, height 2105 mm, from approx. 560 kg

**Load torque:** 25 kNm

**LC\* in longitudinal direction:** 1000 mm

**LC\* in transverse direction:** middle, 50% of the nominal load on one side

**Construction:** Two lift & two tilt cylinders, the platform is hydraulically opened, powerful 3 kW motor

**Lifting arm length:** 800 mm, 950 mm

**Platform:** Aluminium, type N, height 1800/2000/2100/2200/2300/2400 mm, type P, height 1805/2005/2105/2205/2305/2405 mm.

Steel platform primed or hot-dip galvanised on exterior

**Mounting:** For trucks from 18 t, trailers, and semi-trailers

Arm length (in mm)	800	950
F max. = loading height	1355	1561
D max. = distance from mounting on supporting tube to top edge of loading platform	708	827
D min. = distance from mounting on supporting tube to top edge of loading platform	479	553
G max. = distance from mounting of supporting tube to roadway	646	734
E max. = installation space	975	1105
E min. = installation space	720	820
C min. = final height	100	100
C max. = final height	170	170
Platform height minus 67 mm = OK loading area to platform tip		

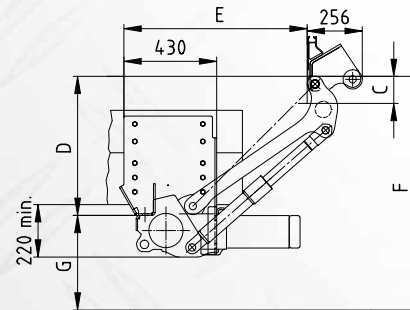

\*Load centre

## DAUTEL *LIFTER* DL 2500S/3000S

The **DAUTEL *LIFTER*** DL 2500S/3000S is designed with a powerful load torque of 30 kNm, for transporting large and heavy cargo. Two heavy pallets can be lifted at the same time with an electric pallet truck.



### DL 2500S load diagram

Load centre	Rated load
1200 mm	2500 kg
1400 mm	2140 kg
1600 mm	1870 kg
1900 mm	1570 kg

### DL 3000S load diagram

Load centre	Rated load
1000 mm	3000 kg
1400 mm	2140 kg
1600 mm	1870 kg
1900 mm	1570 kg

**Rated load:** 2500/3000 kg

## For heavy-duty applications

**Deadweight, e.g.:** Aluminium platform, type P, height 2105 mm, from approx. 625 kg

**Load torque:** 30 kNm

**LC\* in longitudinal direction:** 1200/1000 mm

**LC\* in transverse direction:** middle, 50% of the nominal load on one side

**Construction:** Two lift & two tilt cylinders, the platform is hydraulically opened, powerful 3 kW motor

**Lifting arm length:** 800 mm, 950 mm

**Platform:** Aluminium, type P, height 1805/2005/2105/2205/2305/2405/2505/2605/2705/2805 mm. Steel platform primed or hot-dip galvanised on exterior

**Mounting:** For trucks from 18 t, trailers, and semi-trailers

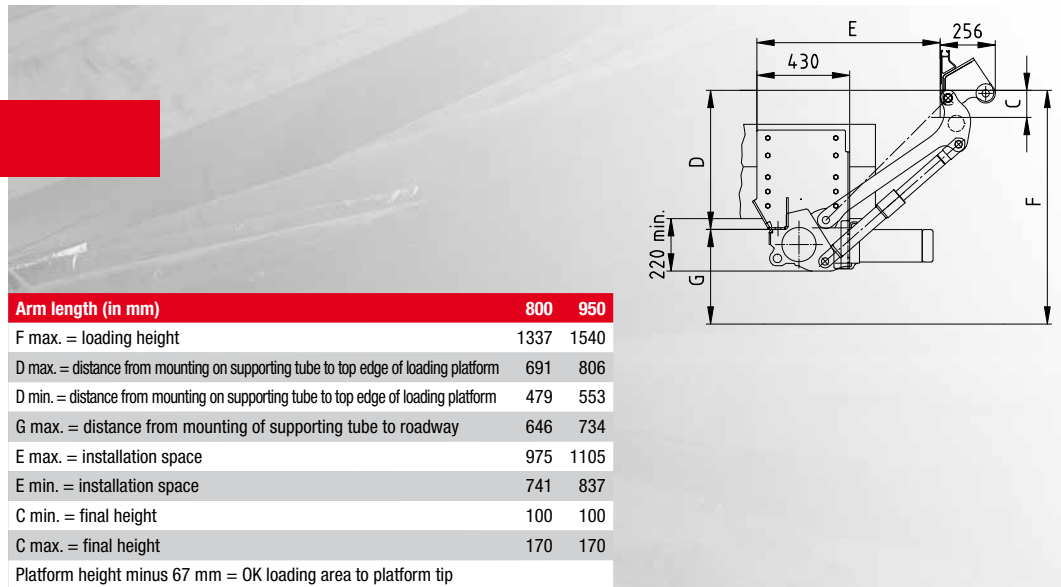

\*Load centre

## DAUTEL LIFTER DL 2000T/2500T

The **DAUTEL LIFTER** DL 2000T/2500T is designed for truck with normal and low coupling for heavy and intensive use in the beverage industry and trade, and in food logistics.

The drive-under protection can be folded hydraulically and is controlled using the outside controller, for solo truck use (folded away), or with a trailer (folded up). In solo truck use, the hydraulically foldable drive-under protection is moved out of the way when the platform is lowered using a float setting fitted to the top. A height of only 120 mm from the underside of the truck's frame in conjunction with bolt-on mounting plates ensures good freedom of movement for the towbar.

### DL 2000T load diagram

Load centre	Rated load
1000 mm	2000 kg
1200 mm	1660 kg
1500 mm	1330 kg
1900 mm	1050 kg

### DL 2500T load diagram

Load centre	Rated load
800 mm	2500 kg
1000 mm	2000 kg
1200 mm	1660 kg
1700 mm	1170 kg



### User-friendly operation

Rated load: 2000/2500 kg

**For trucks with normal and low couplings**

**Deadweight, e.g.:** Aluminium platform, type P, height 2105 mm, from approx. 620 kg

**Load torque:** 20 kNm

**LC\* in longitudinal direction:** 1000/800 mm

**LC\* in transverse direction:** middle, 50% of the nominal load on one side

**Construction:** Two lift & two tilt cylinders, the platform is hydraulically opened

**Lifting arm length:** 1050 mm

**Platform:** **DL 2000T** Aluminium, type K, N & P, height 1800/2000/2100/2200/  
2300/2400/2505/2605/2705/2805 mm, **DL 2500T** Aluminium, type P,

steel platform primed or hot-dip galvanised on exterior

**Mounting:** For trucks with three axles

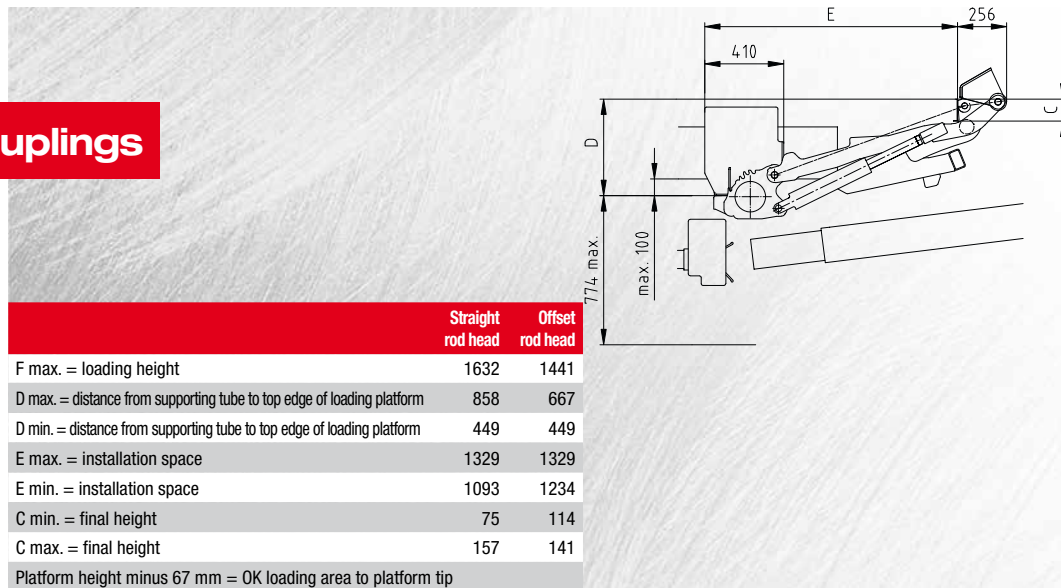

\*Load centre

## DAUTEL *FOLDER* DF 1000, DF 1500L

Loading is just as convenient as with the **DAUTEL LIFTER**, as you can adjust the tilt on the platform. If necessary, the platform packet is positioned hydraulically under the vehicle body, and can be easily unfolded by hand with a spring-balanced mechanism; the lightweight platform tip can be unfolded by hand. Also suited to use with refrigerated bodies, as it has no particular rear closure profile, rather it requires a drive-over profile. It is located under the body in the direction of travel. Loading on ramps or loading docks is possible without using the **DAUTEL FOLDER**.



### DF 1000 load diagram

Load centre	Rated load
700 mm	1000 kg
800 mm	875 kg
900 mm	770 kg
1000 mm	600 kg

### DF 1500L load diagram

Load centre	Rated load
600 mm	1500 kg
800 mm	1125 kg
900 mm	1000 kg
1200 mm	600 kg

**Rated load:** 1000/1500 kg

**Ready for use quickly when needed**

**Deadweight:** DF 1000 approx. 390 kg, DF 1500L approx. 395 kg

**Load torque:** 7 kNm

**LC\* in longitudinal direction:** 700/600 mm

**LC\* in transverse direction:** middle, 50% of the nominal load on one side

**Construction:** Two lift & two tilt cylinders, platform size 1330 x 2200 mm (LxW)

**Mounting:** For trucks with a total weight of 7.49 to 15 t and a frame width of 848 – 864 mm

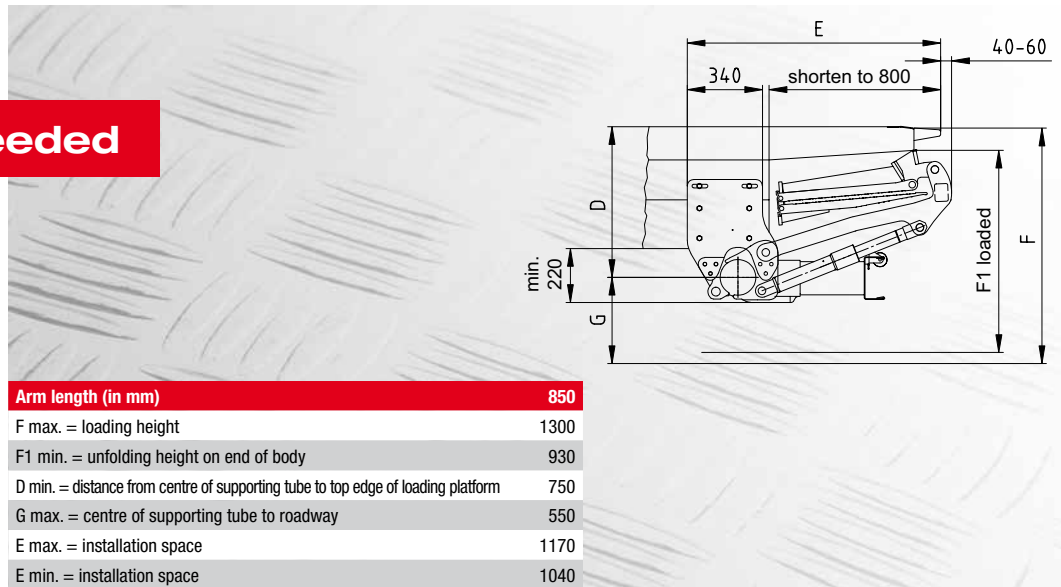

\*Load centre

For transporter chassis 3.5 – 6 t

## DAUTEL SLIDER DS 750/950VE

The **DAUTEL SLIDER** is a horizontally retractable tail-gate lift with a single or double-folding aluminium platform. The innovative combination of parts from the **DAUTEL LIFTERDL 750/950** and **DAUTEL SLIDER** means that you can use minimal installation space on the transporter chassis with a maximum permitted gross weight of 3.5 to 6 t. The platform packet or the platform tip is easily folded in and out by hand with the help of a torsion spring. The **DAUTEL SLIDER DS 750/950VE** is the ideal loading system for applications where loading assistance is only occasionally needed. Loading and unloading can also be done on ramps with a forklift truck or loading docks.



### DS 750VE load diagram

Load centre	Rated load
600 mm	750 kg
1000 mm	450 kg

### DS 950VE load diagram

Load centre	Rated load
500 mm	1000 kg
1000 mm	500 kg

**Rated load:** 750 or 1000 kg

**For a variety of possible applications**

**Load torque:** 4.5 kNm, 5 kNm for 1000 kg

**LC\* in longitudinal direction:** 600 mm, 500 mm for 1000 kg

**LC\* in transverse direction:** middle, 50% of the nominal load on one side

**Construction:** 2 lift cylinders and 2 tilt cylinders

**Platform:** Aluminium platform single-fold, length 1610mm, double-fold, length 1555 mm. Width 2100 mm

**Positioning unit:** double-action hydraulic cylinders, sturdy steel guide rails, low maintenance bearings

**Applications:** Transporter chassis with box body or platform body with sufficient superstructure overhang, preferably Iveco Daily 3.5 – 6 t, Mercedes-Benz Sprinter and VW Crafter 3.5 – 5 t

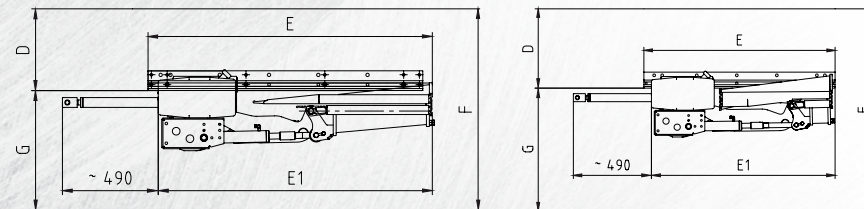

	DS 750/950VE single fold	DS 750/950VE double fold	
<b>Arm length (in mm)</b>	<b>570</b>	<b>670</b>	<b>670</b>
F max. = loading height	1020	1160	1260
D max. = distance from centre supporting tube to top edge of loading platform	415	495	495
G max. = centre of supporting tube to roadway	605	665	765
E min. = installation space	1440	1540	1200
E1 min. = mudguard installation space	1390	1490	1145

\*Load centre

**DAUTEL DL LIFTERFLEX**

**DAUTEL DS 1500VA/2000VA SLIDERFLEX**

## DAUTEL LIFTERFLEX · SLIDERFLEX

With the *LIFTERFLEX*, **DAUTEL LIFTER** DL 1500S to 2000S can be installed on trucks with a trailer hitch in the standard position and with BDF swap bodies of various lengths, e.g. C715 and C745. The **DAUTEL LIFTER** is not mounted rigidly to the vehicle frame, but rather is hydraulically adjustable.

The *SLIDERFLEX* combines the advantages of the retractable and standard versions, **DAUTEL SLIDER** and **DAUTEL LIFTER**. Loading and unloading on ramps is possible. With a special locking mechanism, the foldable platform becomes a rigid drive-over ramp, drive-over load max. 1000 kg, optionally 1500 kg. It is mounted to trucks with road bed bodies.



**DS 1500VA load diagram**

Load centre	Rated load
1000 mm	1500 kg
1500 mm	1000 kg

**DS 2000VA load diagram**

Load centre	Rated load
750 mm	2000 kg
1200 mm	600 kg

## Retractable and standard tail-gate lift

Rated load: 1500/2000 kg

**2 in 1**

**Deadweight:** DS 1500 approx. 620 kg, DS 2000VA approx. 640 kg

**Load torque:** 15/16 kNm

**LC\* in longitudinal direction:** 1000/800 mm

**LC\* in transverse direction:** middle, 50% of the nominal load on one side

**Construction:** Two lift & two tilt cylinders, positioning cylinder,  
2 retracted positions

**Platform:** Foldable aluminium platform, 1800 x 2300 mm, (HxW),  
for two-axle trucks with a permitted total weight of up to 18 t

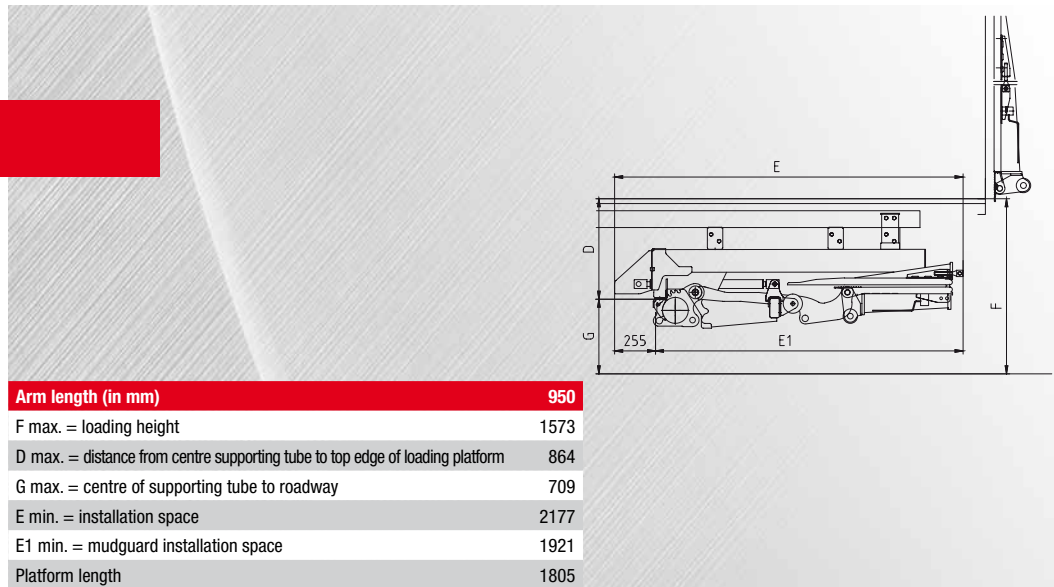

\*Load centre

For trucks with BDF changeable superstructures or short superstructure overhang

## DAUTEL SLIDER DS 1500/2000VAL/VA

The **DAUTEL SLIDER** is a horizontally retractable tail-gate lift with a double-folding platform. Independent of fixed loading devices, with its large platform, it is the perfect loading system for hauliers, works transport, and delivery traffic. BDF swap bodies can be deposited on ramps or loading docks directly, or loaded with a forklift/pallet truck. The platform packet is extended hydraulically under the vehicle body, and can optionally be unfolded by hand with a spring-assisted mechanism (DS 1500/2000VA); the lightweight platform tip can be unfolded by hand. With the foldable bridging plate mounted to the platform with automatic return during the lowering process, you can bridge locking parts or rubber bumpers, (DS 1500/2000VA).

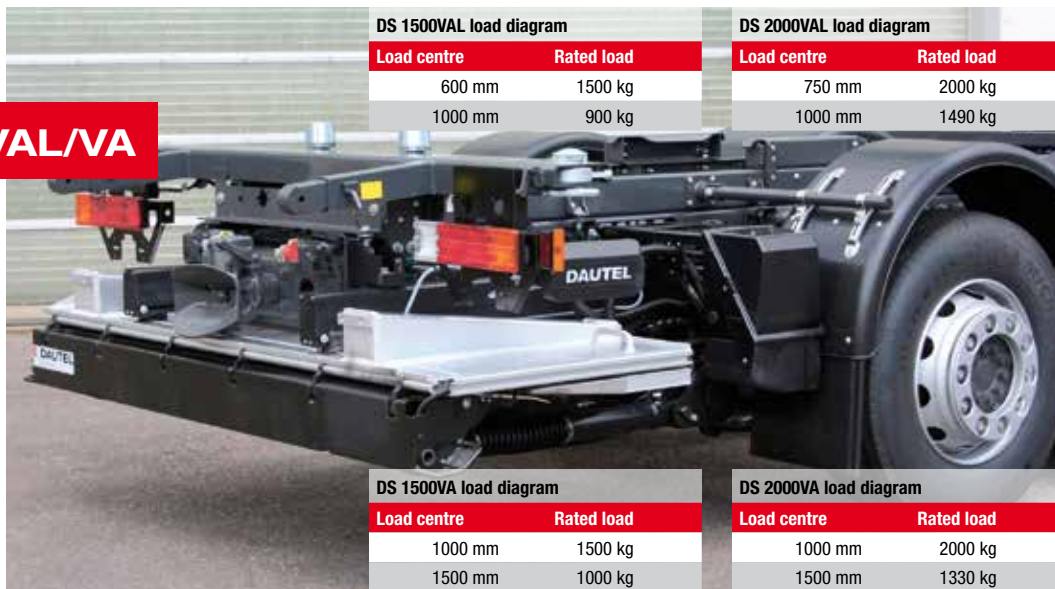

DS 1500VAL load diagram

Load centre	Rated load
600 mm	1500 kg
1000 mm	900 kg

DS 2000VAL load diagram

Load centre	Rated load
750 mm	2000 kg
1000 mm	1490 kg

DS 1500VA load diagram

Load centre	Rated load
1000 mm	1500 kg
1500 mm	1000 kg

DS 2000VA load diagram

Load centre	Rated load
1000 mm	2000 kg
1500 mm	1330 kg

**With approx. 25% more torque than the market standard**

**Rated load:** 1500/2000 kg · **Deadweight:** from approx. 470 kg

## Powerful torque

**Load torque:** VAL 9 kNm or 15 kNm, VA 15 kNm or 20 kNm

**LC\* in longitudinal direction:** VAL 600 or 750 mm, VA 1000 mm

**LC\* in transverse direction:** middle, 50% of the nominal load on one side

**Construction:** Two lift cylinders & two tilt cylinders

**Platform:** Type VAL: Aluminium platform, double-folded, length 1580, 1760 mm incl. drive-over profile, width 2300 mm, Type VA: steel/aluminium platform, double-folded, length 1540, 1740 and 1950 mm, width 2300 mm

**Positioning unit:** double-action hydraulic cylinders, sturdy aluminium guide rails and low-maintenance roller/bearing guide

**Applications:** Rigid superstructures with short superstructure overhang, trucks with low & normal coupling, DS 1500-2000VA for trucks with BDF changeable superstructures

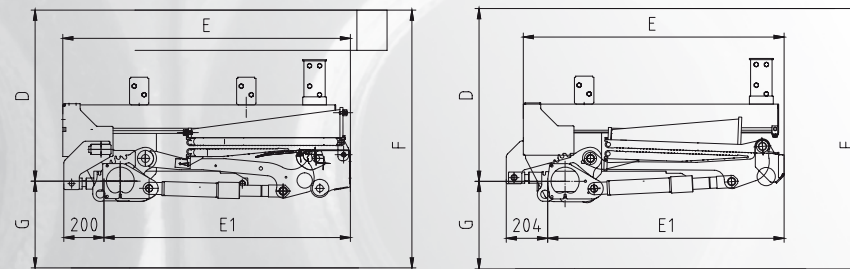

Arm length (in mm)	DAUTEL SLIDER DS-VA			DAUTEL SLIDER DS-VAL		
	850	950	1050	850	950	1050
F max. = loading height	1433	1573	1714	1477	1623	1770
D max. = distance from centre supporting tube to top edge of loading platform	852	934	1016	817	895	973
Platform length max.	1540	1740	1950	1580	1760	1760
G max. = centre of supporting tube to roadway	581	639	698	660	729	796
E max. = installation space	1432	1532	1632	1288	1388	1488
E1 min. = mudguard installation space	1227	1327	1427	1168	1268	1368

\*Load centre

For trucks with box body/platform body

## DAUTEL SLIDER DS 1500/2000VAL/VA

The **DAUTEL SLIDER** is a horizontally retractable tail-gate lift with a single-folding platform for trucks with a large superstructure overhang. It makes the operator independent of fixed loading devices. With its large platform, the **DAUTEL SLIDER** is the perfect loading system for hauliers, works transport, and delivery traffic. Box or platform bodies can be loaded with a forklift/pallet truck on ramps or loading docks directly. The platform tip is unfolded by hand with a spring-assisted mechanism.



### DS 1500VAL load diagram

Load centre	Rated load
600 mm	1500 kg
1000 mm	900 kg

### DS 1500VA load diagram

Load centre	Rated load
1000 mm	1500 kg
1200 mm	1250 kg

### DS 2000VAL load diagram

Load centre	Rated load
750 mm	2000 kg
1000 mm	1500 kg

### DS 2000VA load diagram

Load centre	Rated load
1000 mm	2000 kg
1200 mm	1660 kg

**With approx. 25% more torque than the market standard**

**Rated load:** 1500/2000 kg · **Deadweight:** from approx. 455 kg

## Powerful torque

**Load torque:** VAL 9 kNm or 15 kNm, VA 15 kNm or 20 kNm

**LC\* in longitudinal direction:** VAL 600 or 750 mm, VA 1000 mm

**LC\* in transverse direction:** middle, 50% of the nominal load on one side

**Construction:** Two lift cylinders & two tilt cylinders

**Platform:** Aluminium platform single-fold, length 1605 and 1808 mm, incl. drive-over profile, width 2400 mm

**Positioning unit:** hydraulic cylinder, sturdy aluminium guide rails

**Applications:** Trucks with fixed bodies and an adequate overhang of the body, trailer hitch, semi-trailer.

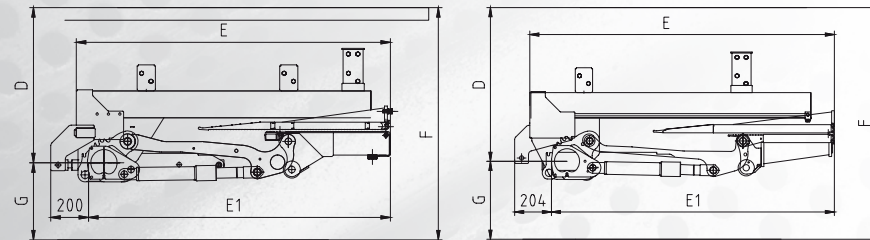

Arm length (in mm)	DAUTEL SLIDER DS-VA			DAUTEL SLIDER DS-VAL	
	850	950	1050	850	950
F max. = loading height	1433	1573	1714	1477	1623
D max. = distance from centre supporting tube to top edge of loading platform	852	934	1016	817	895
Platform length max.	1620	1720	1820	1605	1808
G max. = centre of supporting tube to roadway	581	639	698	660	729
E min. = installation space PH 1620	1661	1761	1861	1688	1788
E min. = installation space PH 1720/1820	1761	1861	1961	1891	1991
E1 min. = mudguard installation space PH 1620	1596	1696	1796	1568	1668
E1 min. = mudguard installation space PH 1720/1820	1696	1796	1896	1770	1870

\*Load centre

For trucks with box body/platform body

## DAUTEL SLIDER DS 2500/3000VA

The **DAUTEL SLIDER** is a horizontally retractable tail-gate lift with a single-folding platform for trucks with a large superstructure overhang. It makes the operator independent of fixed loading devices. With a large platform up to 2020 mm and super rated load of 2500/3000 kg at a very long load centre of 960/800 mm, the **DAUTEL SLIDER** is the perfect loading system for heavy loads for hauliers, works transport, and delivery traffic. Its handling is the same as the **DAUTEL SLIDER DS 1500/2000VA**.

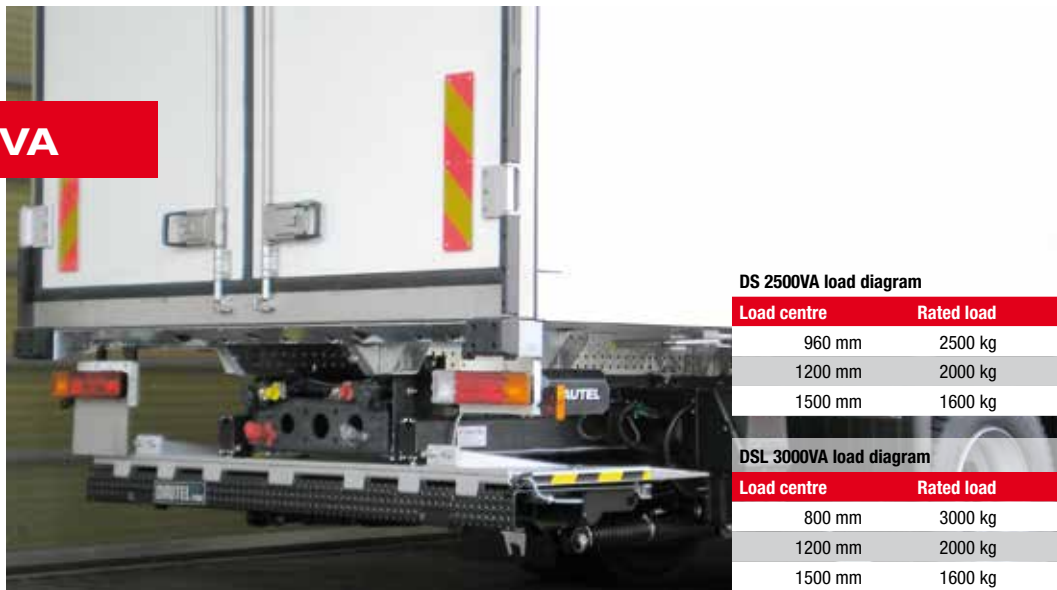

DS 2500VA load diagram

Load centre	Rated load
960 mm	2500 kg
1200 mm	2000 kg
1500 mm	1600 kg

DSL 3000VA load diagram

Load centre	Rated load
800 mm	3000 kg
1200 mm	2000 kg
1500 mm	1600 kg

### Extreme torque and performance

**Rated load:** 2500/3000 kg · **Deadweight:** from approx. 665 kg

## Extremely high performance

**Load torque:** 24 kNm

**LC\* in longitudinal direction:** 960 or 800 mm

**LC\* in transverse direction:** middle, 50% of the nominal load on one side

**Construction:** Two lift cylinders & two tilt cylinders

**Platform:** foldable steel/aluminium platform with 1 folding tip, length 1620, 1720 and 1820 mm + 70 mm drive-over strip for optimal loading and unloading, width 2400 mm

**Positioning unit:** double-action hydraulic cylinders, sturdy aluminium guide rails and low-maintenance roller/bearing guide

**Applications:** Trucks with fixed bodies and an adequate overhang of the body, trailer hitch, semi-trailer.

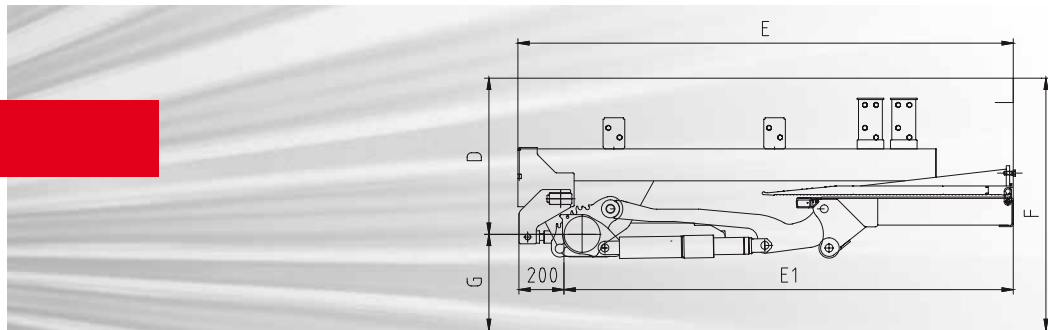

Arm length (in mm)	950
F max. = loading height	1555
D max. = distance from centre supporting tube to top edge of loading platform	891
G max. = centre of supporting tube to roadway	664
E min. = installation space	2200
E1 min. = mudguard installation space	1996
Platform length	1820/2020/2220

\*Load centre

For trucks with low couplings

## DAUTEL *SLIDER* DS 1500/2000VT

The **DAUTEL** *SLIDER* DS 1500/2000VT for trucks with a loading height/ depositing height of 1020–1320 mm, coupling return min. 1400 max. 1600 mm, with fixed and BDF swap body. The low-height variant of the lift with offset supporting tube enables optimum freedom of movement for the towbar. The truck frame must be tapered depending on the attachment situation. For a lower loading height, the tail lights and number plate can be integrated into the platform.



**Large loading volume – Reduced costs**

**Rated load:** 1500/2000 kg

**Extremely high performance**

**Deadweight:** Type VT from approx. 565 kg

**Load torque:** 12 kNm

**LC\* in longitudinal direction:** 800/600 mm

**LC\* in transverse direction:** middle, 50% of the nominal load on one side

**Construction:** Two lift cylinders & two tilt cylinders

**Platform:** foldable steel/aluminium platform with 1 folding tip, length 1720, width 2400 mm, easy folding/unfolding of the platform tip by hand with a spring-balanced mechanism

**Positioning unit:** double-acting hydraulic cylinder, steel guide rails

**Applications:** Trucks with frame width 752 to 770 mm, 18 to 26 t, with low coupling, BDF swap body C745/782

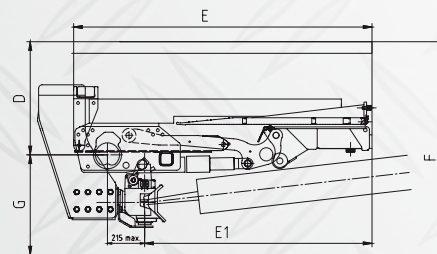

**DAUTEL SLIDER DS-VT**

<b>Arm length (in mm)</b>	<b>850</b>	<b>950</b>
F max. = loading height	1474	1619
D max. = distance from centre supporting tube to top edge of loading platform	813	890
G max. = centre of supporting tube to roadway	661	729
E min. = installation space	1725	1825
E1 = position of low coupling	1300	1400
Platform length	1720	1720

\*Load centre

For semi-trailer with track width 1300 mm

## DAUTEL SLIDER DS 1500VBL-3000VB

The **DAUTEL SLIDER** is a horizontally retractable tail-gate lift with a single-folding platform. Independent of fixed loading devices, with its large platform, it is the perfect loading system for hauliers, works transport, and delivery traffic. Loading and unloading can also be done by forklift or on ramps. The platform packet is extended hydraulically under the vehicle body, the platform tip can easily be unfolded by hand with a spring-assisted mechanism. It is mounted using **DAUTEL CLAMP-ON** mounting technology, which can be screwed on to the longitudinal beam lower flanges of the semi-trailer.

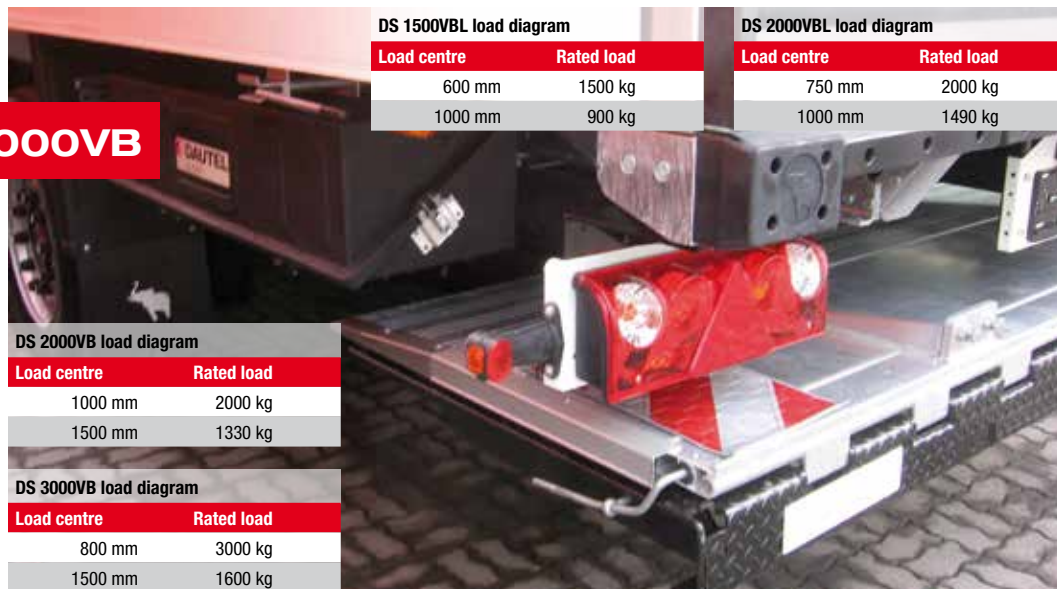

DS 1500VBL load diagram

Load centre	Rated load
600 mm	1500 kg
1000 mm	900 kg

DS 2000VBL load diagram

Load centre	Rated load
750 mm	2000 kg
1000 mm	1490 kg

DS 2000VB load diagram

Load centre	Rated load
1000 mm	2000 kg
1500 mm	1330 kg

DS 3000VB load diagram

Load centre	Rated load
800 mm	3000 kg
1500 mm	1600 kg

**DS 2000VB with approx. 25 – 33% more torque than the market standard**

**Rated load:** 1500 – 3000 kg · **Deadweight:** from approx. 480 kg without battery compartment

**With powerful torque**

**Load torque:** 9/15/20/24 kNm

**LC\* in longitudinal direction:** 600/750/1000/800 mm

**LC\* in transverse direction:** middle, 50% of the nominal load on one side

**Construction:** Two lift cylinders & two tilt cylinders

**Platform:** Type VBL; aluminium platform, single fold, 1808 mm incl. drive-over profile, Type 2000 VB aluminium platform, single fold, 1808, 2015 and 2215 mm incl. drive-over profile, Type 3000 VB; foldable steel platform with aluminium folding tip, length 1820, 2020 & 2220 mm + 70 mm drive-over strip for optimum loading and unloading, width 2400 mm

**Positioning unit:** double-action hydraulic cylinders, sturdy aluminium guide rails and low-maintenance roller/bearing guide

**Applications:** Semi-trailers, centre-axle trailers with approx. track width 1300 mm

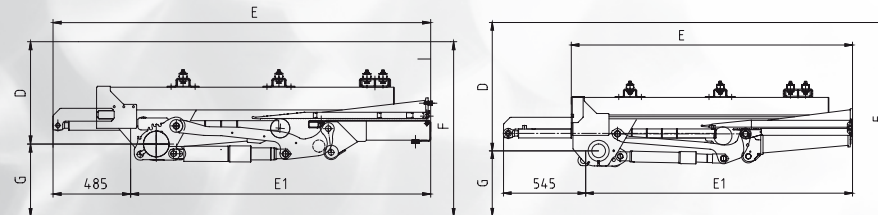

	DAUTEL SLIDER DS-VB		DAUTEL SLIDER DS-VBL	
Arm length (in mm)	950	850	950	
F max. = loading height	1555	1477	1623	
D max. = distance from centre supporting tube to top edge of loading platform	891	817	895	
G max. = centre of supporting tube to roadway	664	660	729	
E min. = installation space PH 1820	2360	PH 1808	1866	1966
E1 min. = mudguard installation space PH 1820	1875	PH 1808	1770	1870
E min. = installation space PH 2020/2220	2560			
E1 min. = mudguard installation space PH 2020/2220	2075			
Platform length	1820/2020/2220	1808	1808	

\*Load centre

## The best solution...

Alongside the already mentioned additional equipment, you can optionally outfit your **DAUTEL LIFTER/FOLDER/SLIDER** to meet your requirements, e.g.:

1. Towing bracket for ball coupling  
DL 500K D-value 17.5 kN  
DL 750/950 D-value 20.5 kN  
DFL 750 D-value 20.5 kN  
DFL 1000 – 1500 D-value 23.5 kN  
DL 1000 – 3000S D-value 31 kN  
DF 1000 – 1500L D-value 20.5 kN  
Step on the under-run guard

2. Protection angles for indicators on the platform
3. Mechanical support
4. Hydraulic support with safety circuit system, hydraulic support retracts automatically approx. 15° before closing the platform
5. Bio hydraulic oil Panolin Synth 15
6. Sound-absorbing plastic coating on the platform
7. Fixorand profile
8. Powerful 3 kW motor for DL 2000S/T
9. Thanks to a variety of measures, **DAUTEL LIFTER, FOLDER** and **SLIDER** meet the requirements according to ADR, class OX through EX/III. Please submit your enquiries to us.

10. Clamp-on, the screw-down mounting technology for **DAUTEL LIFTER** DL 1500S – 2000S on the longitudinal beam lower flanges of semi-trailers
11. Loading rails for driving off the side onto the pavement
12. Seal system for truck body  
Variant 1: with rubber wedge profile and stops for lifting arm  
Variant 2: with aluminium stop profile on bottom with lip seal
13. Low-temperature model
14. Interface for "Scharfenberger system"

...for any application

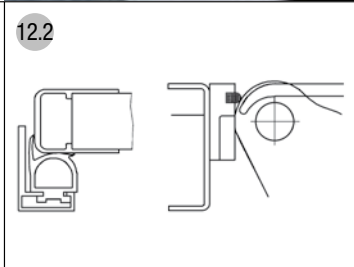
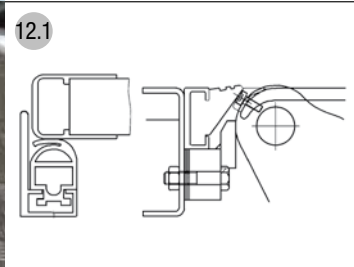

**For every application, in every industry**



## Recommended truck equipment

The mounting options for a tail-gate lift are regulated by the installation guidelines from the truck manufacturer. They must be observed by the body manufacturer during installation.

To ensure a reliable supply of power to the **DAUTEL LIFTER/FOLDER/SLIDER**, we recommend the following electrical equipment:

Three-phase generator:

- At least 14V/45A or 28V/27A

- Use only in city traffic/urban areas, approx. 14V/80A or 28V/55A
- Tractors with semi-trailers/trailers, 28V/55A

### Battery capacity

Rated load kg	Light use	Heavy use
500 – 1000	12V, 1x110 Ah	Not recommended
1000 – 1500	12V, 1x143 Ah	12V, 1x180 Ah
1000 – 1500	24V, 2x110 Ah	24V, 2x143 Ah
1500 – 2000	24V, 2x143 Ah	24V, 2x170 Ah
2000 – 3000	24V, 2x200 Ah	24V, 2x200 Ah

If major power consumers other than the **DAUTEL LIFTER**, **FOLDER** and **SLIDER** have been installed in the vehicle, then their consumption must also be considered.

If the truck manufacturer offers a preparatory kit for a tail-gate lift, you should equip your truck with it. e.g. code MAN 320EC, Mercedes-Benz E33.

## How to request a quotation

We would be pleased to present you with a non-binding quotation. In order to do so, we will require the following information from you:

Desired tail-gate lift model

- **DAUTEL** *LIFTER*
- **DAUTEL** *FOLDER*
- **DAUTEL** *SLIDER*
- Rated load
- Platform length
- Roll stops, if so, wheel diameter of the roller container and its size L x W

- Towing bracket for ball coupling
- Any special equipment

Required vehicle information:

- Make and model
- Wheelbase
- Body, e.g. platform, box, BDF swap body
- Body length and width
- Trailer hitch yes/no

We will then be able prepare our quotation for you in short order.

How to contact us:

Telephone: +49 7131 407-155 or 156

Fax: +49 7131 407-107

e-mail: [info@dautel.de](mailto:info@dautel.de)

**Technical data, deadweight (kg) of the DAUTEL FLEETLIFTER and LIFTER**

	<b>DAUTEL FLEETLIFTER</b>			<b>DAUTEL LIFTER</b>										
<b>Platform, type K and N</b>	750	1000	1500	750	950A	950B/C	1000	1500L	1500S	2000L	2000S	2500L	2000T	2500T
Flat platform, 1455 mm.	180			200										
Flat platform, 1605 mm.	190			210	245	255								
Flat platform, 1805 mm.		255		220										
Platform K, 1600 mm.							350	365						
Platform K, 1800 mm.			305				355	375	460	470	515		615	
Platform K, 2000 mm.									470	480	520		620	
Platform K, 2100 mm.								400	475	485	525		625	
Platform K, 2200 mm.									485	595	535		635	
Platform K, 2300 mm.									490	500	540		645	
Platform K, 2400 mm.									495	505	545		650	
Platform N, 1600 mm.							345	360						
Platform N, 1800 mm.			300				350	370	455	465	510	560	620	630
Platform N, 2000 mm.									465	475	515	565	625	635
Platform N, 2100 mm.							380	395	470	480	520	570	630	640
Platform N, 2200 mm.									480	490	530	580	640	650
Platform N, 2300 mm.									485	495	535	585	645	655
Platform N, 2400 mm.									490	500	540	590	650	660

Technical data, deadweight (kg) of the **DAUTEL LIFTER**

<b>DAUTEL LIFTER</b>								
Platform, type P	1500S	2000L	2000S	2500L	2500S	3000S	2000T	2500T
1805 mm	460	470	515	565	595	595	640	650
2005 mm	470	480	525	575	615	615	650	660
2105 mm	475	485	530	580	625	625	655	665
2205 mm	485	495	540	590	635	635	665	675
2305 mm	490	500	545	595	645	645	670	680
2405 mm	500	510	555	605	655	655	680	690
2505 mm			565		665	665	690	
2605 mm			570		675	675	695	
2705 mm			575		685	685	700	
2805 mm			580		695	695	705	

Note

The values stated for deadweight are approximate values, as we supply the appropriate variant for the specific mounting case, with different arm length and mounting plates.

**Technical data, deadweight (kg) of the DAUTEL FOLDER and SLIDER**

	<b>DAUTEL FOLDER</b>		<b>DAUTEL SLIDER</b>					
	1000	1500L	DS 1500VAL	DS 1500VA	DS 2000VAL	DS 2000VA	DS 2500VA	DS 3000VA
1330 mm, double fold	390	395						
1540 mm, double fold				585		600		
1580 mm, double fold			480		490			
1740 mm, double fold				595		610		
1760 mm, double fold			490		500			
1950 mm, double fold				605		620		
1605 mm, single fold			465		475			
1620 mm, single fold				545		560		
1720 mm, single fold				555		570		
1808 mm, single fold			475		485			
1820 mm, single fold				560		575	675	675
2020 mm, single fold							685	685
2220 mm, single fold							695	695

Note

The values stated for deadweight are approximate values, as we supply the appropriate variant for the specific mounting case, with different arm length and mounting plates.

Technical data, deadweight (kg) of the **DAUTEL SLIDER**

<b>DAUTEL SLIDER</b>						
	1500VBL	2000VBL	2000VB	3000VB	1500/2000VT	1500/2000VT XXL
1808 mm, single fold	480	495				
1620 mm, single fold					565	
1720 mm, single fold					570	1200
1820 mm, single fold			550	655		
2020 mm, single fold			560	665		
2220 mm, single fold			570	675		
Note	The values stated for deadweight are approximate values, as we supply the appropriate variant for the specific mounting case, with different arm length and mounting plates.					

## **DAUTEL Your Partner**

**DAUTEL** GmbH

Dieselstrasse 33

74211 Leingarten · Germany

Switchboard phone: ++49 7131 407-0

Marketing Dept. phone: +49 7131 407-155 and 156

Customer Service Dept. phone: +49 7131 407-222

Sales Dept. fax: +49 7131 407-107

Customer Service Dept. fax: +49 7131 407-333

e-mail: [info@dautel.de](mailto:info@dautel.de)

Website: [www.dautel.de](http://www.dautel.de)

**DAUTEL** is certified in accordance with ISO 90012008.

Maintenance and servicing work are carried out by over 670 Dautel-trained service support points in Germany and over 250 more across Europe.

Spare parts are supplied at short notice and at a reasonable price over night.

Our Customer Service staff in Leingarten are available:

**Monday to Friday from 7.15am to 6.00pm** and

**Saturday from 7.15am to 12.00pm**

Technical data subject to change, illustrations non-binding. 08/2016

## DAUTEL EXPORTLIFTER DEL 1000

The **DAUTEL** *EXPORTLIFTER* DEL 1000 is designed for universal use in delivery traffic for all sectors, for lightweight loads up to 1000 kg at a load centre of 600 mm from the start/centre of the platform. The robust four-cylinder design, with single-part, fold-down under-run guard, offers the user the maximum payload for their truck with a very low deadweight of just approx. 275 kg. The platform is hydraulically opened. The platform height is 1805mm. It can be installed on trucks a frame width of 700–880 mm. The mounting plates have to be welded on the main frame, according to the frame width of the truck.



DEL 1000 load diagram

Load centre	Rated load
600 mm	1000 kg
800 mm	750 kg
1000 mm	600 kg

## DAUTEL EXPORTLIFTER

Rated load: 1000 kg

**For distribution**

**Deadweight:** approx. 275 kg

**Load torque:** 6 kNm

**LC\* in longitudinal direction:** 600 mm

**LC\* in transverse direction:** middle, 50% of the nominal load on one side

**Construction:** Two lift & two tilt cylinders, the platform is hydraulically opened

**Lifting arm length:** 820 mm, 900 mm

**Platform:** Aluminium, flat design, height 1805 mm

**Mounting:** For trucks of frame width 700 – 880 mm

Arm length (in mm)	820	900
F max. = loading height	1220	1320
D max. = distance from centre of swing bolt to top edge of loading platform	541	596
D min. = distance from centre of swing bolt to top edge of loading platform	452	498
G max. = centre of swing bolt to roadway	681	727
E max. = installation space	900	966
E min. = installation space	828	887
C min. = final height	126	126
C max. = final height	132	132

Platform height minus 57 mm = OK loading area to platform tip

\*Load centre

